

INSTRUCTIONS

ADP1100 REV# 2
ADP1105

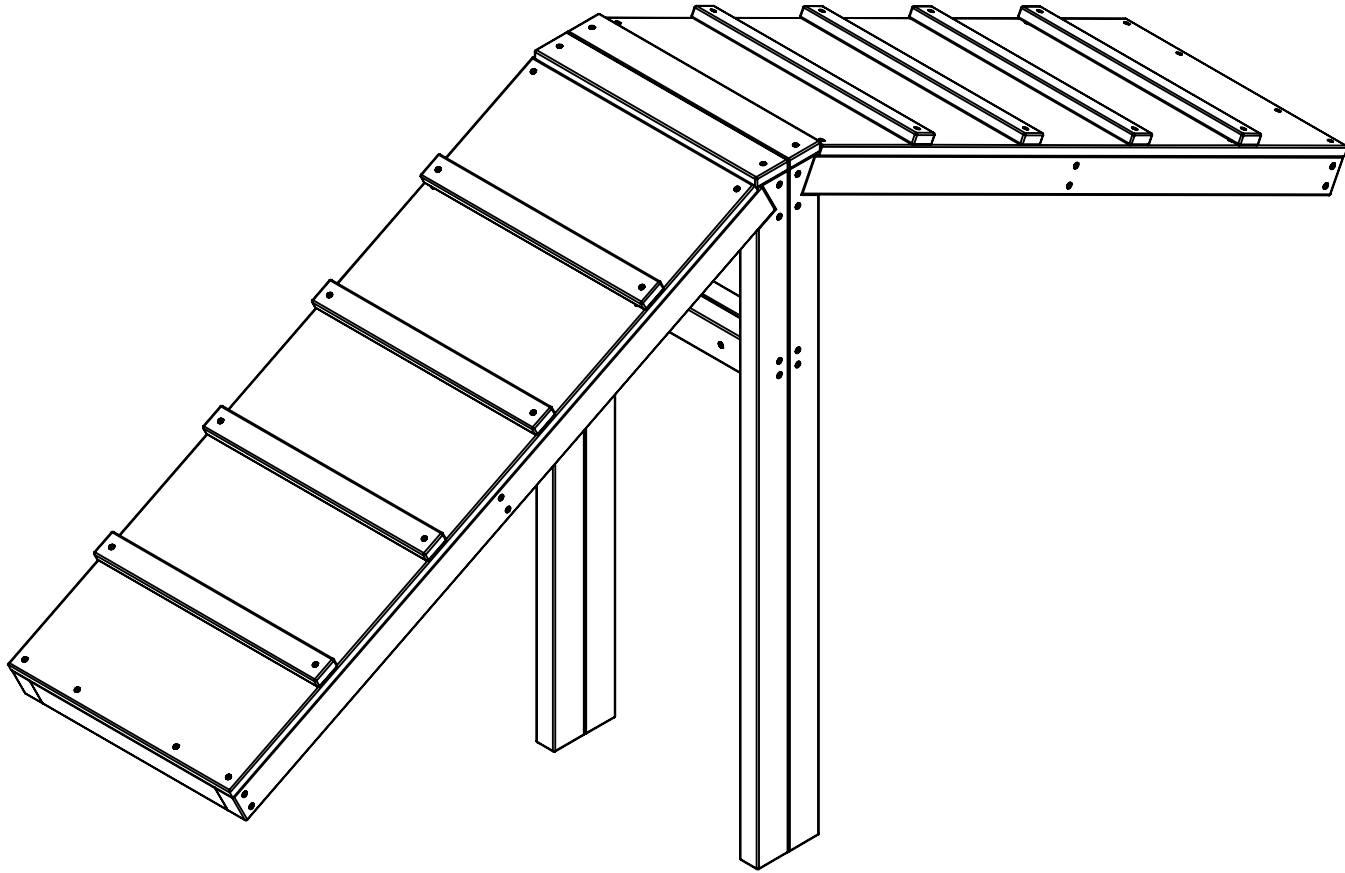

INSTRUCTIONS

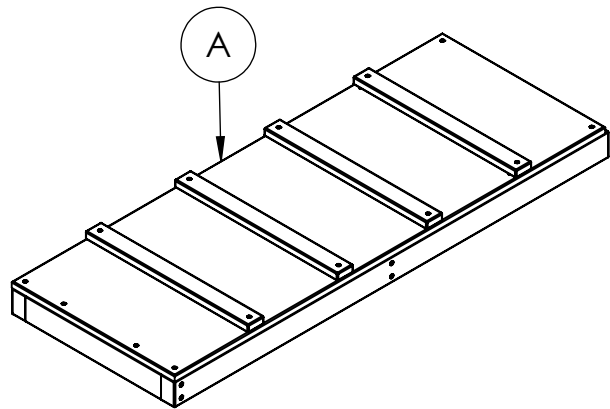

2
RAMP PLATFORM

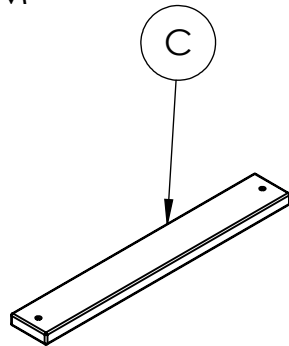

2
RAMP TOP
PLATE

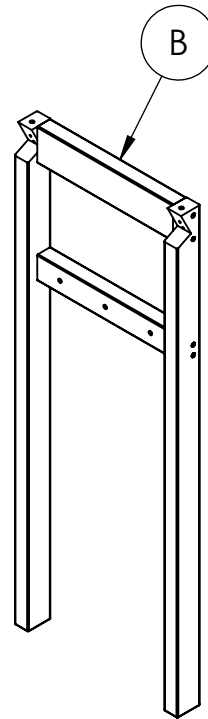

2
RAMP LEG
ASSEMBLY
(INGROUND PICTURED)

HARDWARE

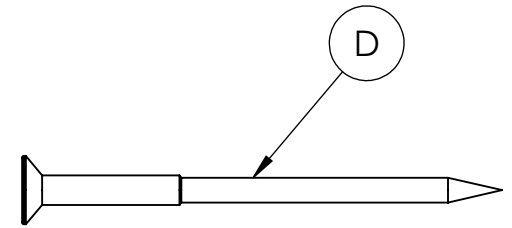

11
#10 x 2.5"
FLAT HEAD SCREW

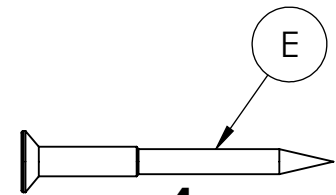

4
#8 x 1.625"
FLAT HEAD SCREW

REQUIRED TOOLS (NOT INCLUDED)

- POWER DRILL
- #2 SQUARE DRIVE

**HARDWARE &
TOOLS REQUIRED
FOR ASSEMBLY**

2/6

INSTRUCTIONS

NOTE: ATTACH RAMP PLATFORM (A)
BEFORE TOP PLATE (C)

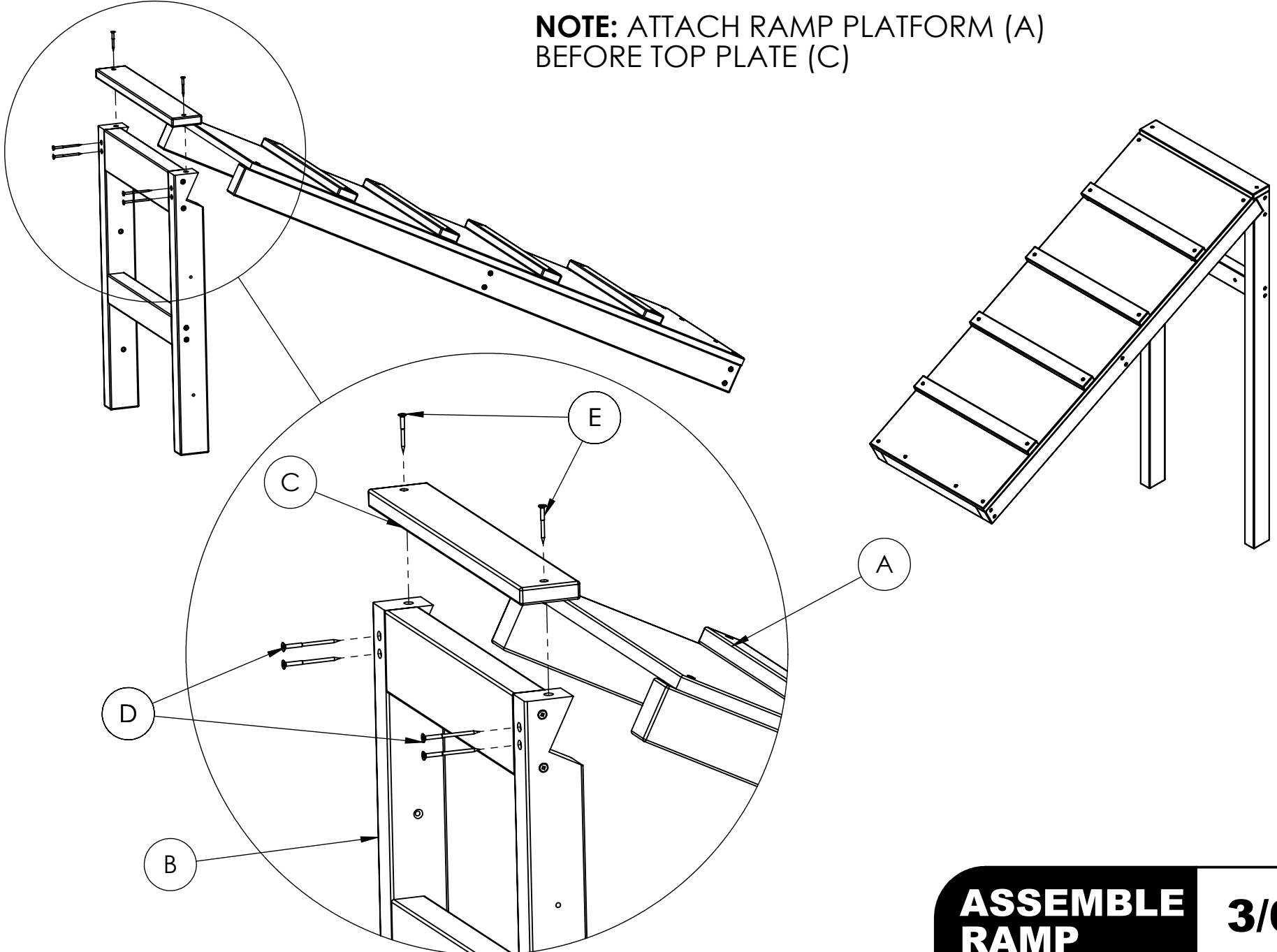

INSTRUCTIONS

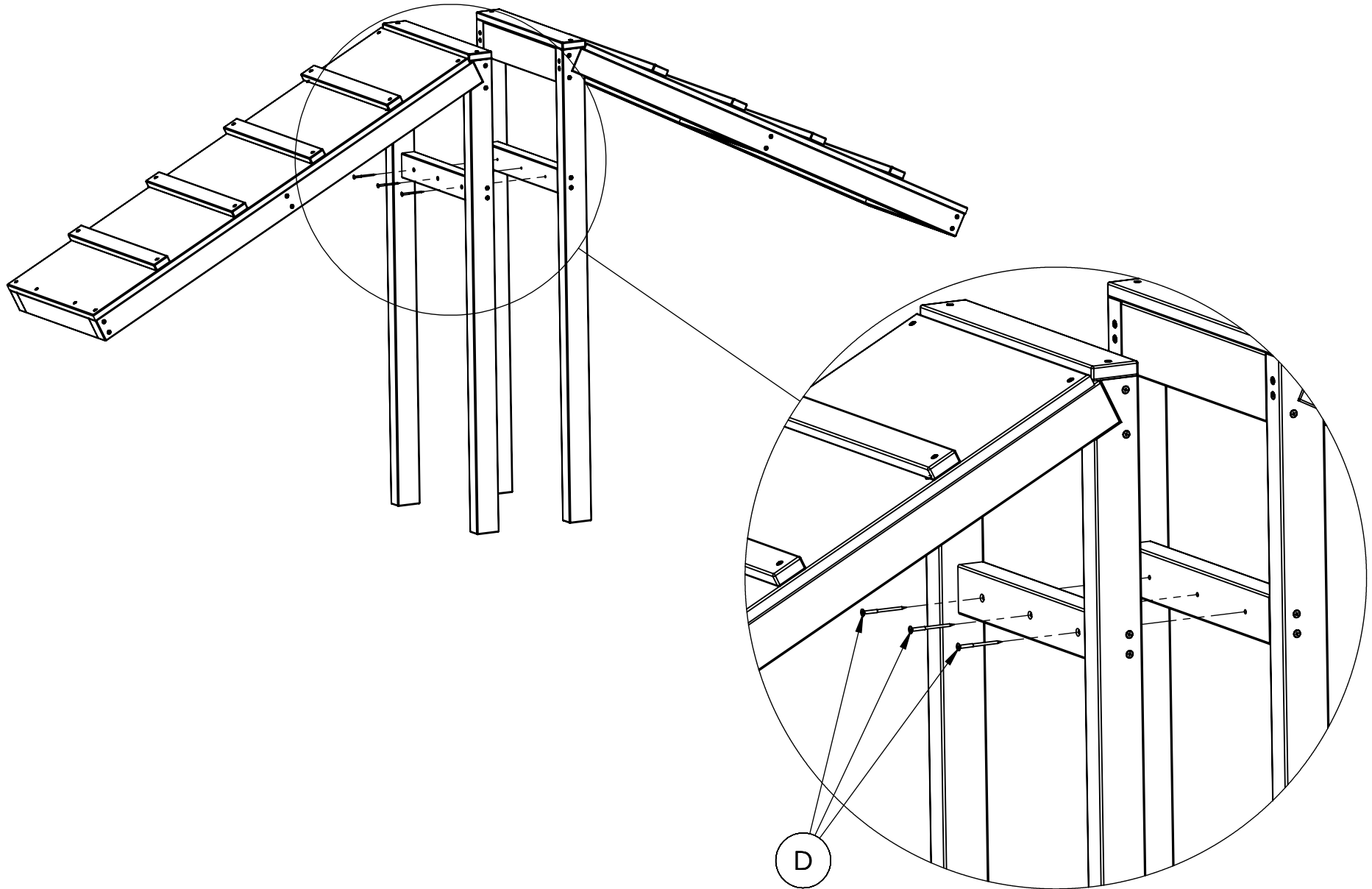

**ATTACH
RAMP**

4/6

INSTRUCTIONS

INGROUND MOUNT ONLY DP1100

DIG TWO HOLES APPROXIMATELY 6" IN DIAMETER
AND 16.45" APART IN DESIRED LOCATION.
PLACE ASSEMBLY INTO HOLES.
ASSEMBLY SHOULD STAND 24.5 INCHES ABOVE GROUND

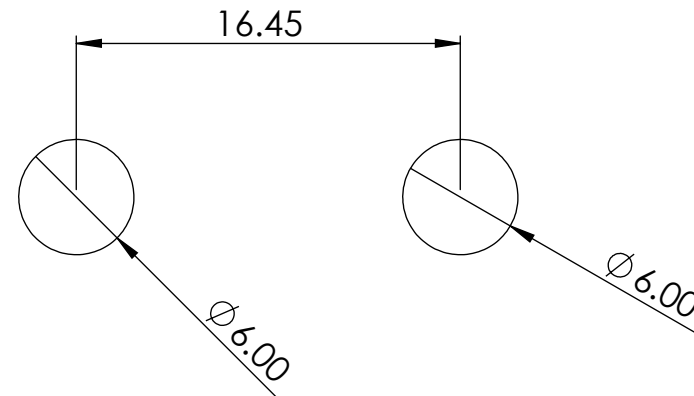
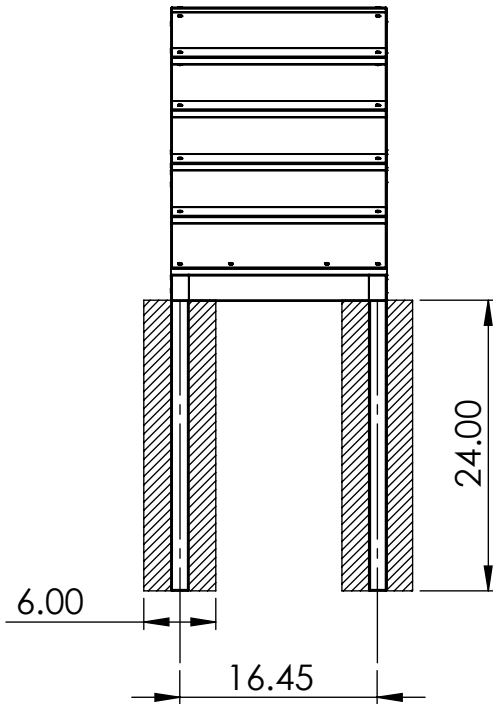

SPECIFICATIONS

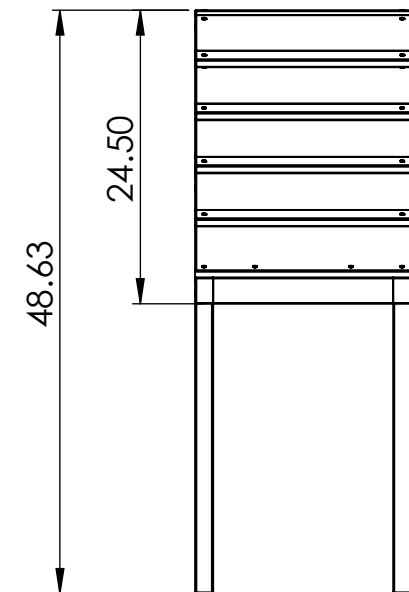
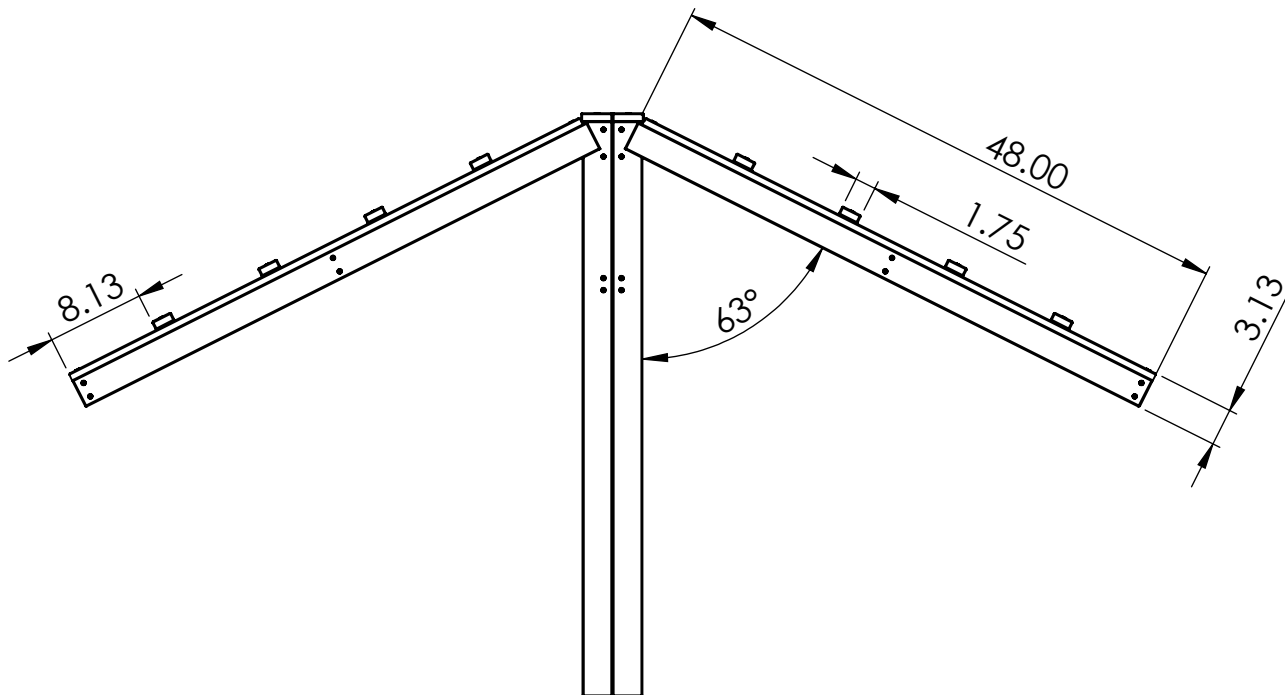
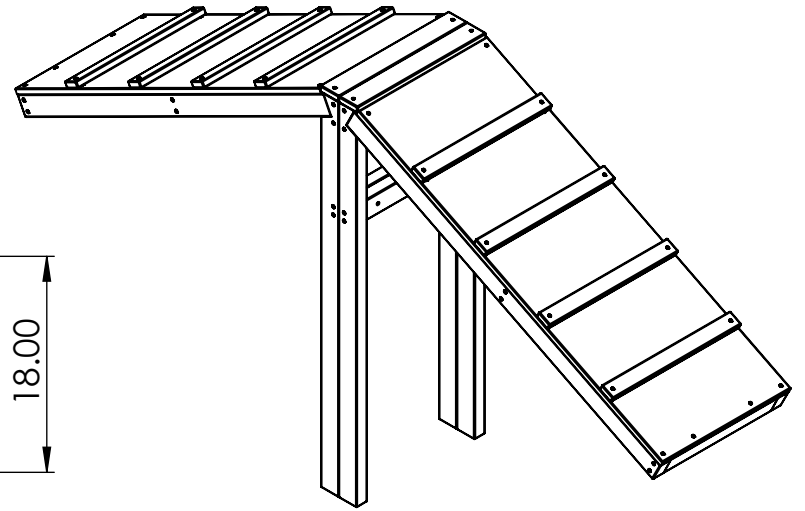
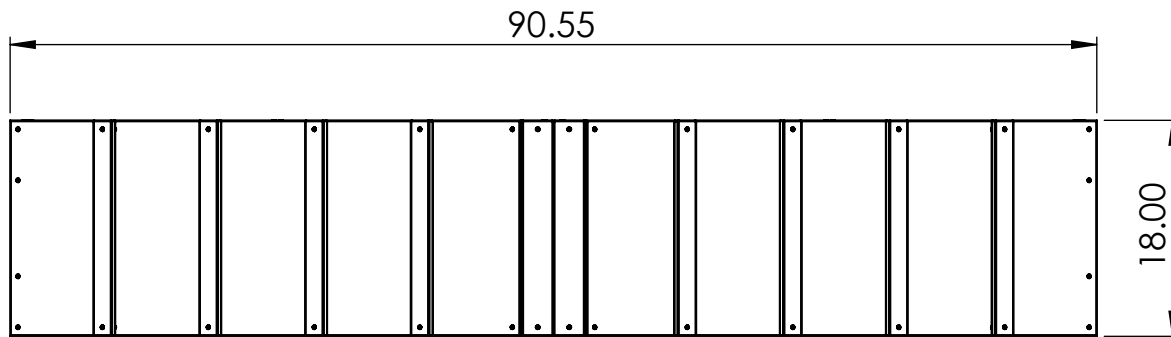

CONSTRUCTION MATERIALS:
Recycled Plastic
HARDWARE:
Stainless Steel

ALL DIMENSIONS SHOWN IN INCHES