

# FOUR SIDED KIOSK INGROUND MOUNT INSTRUCTIONS

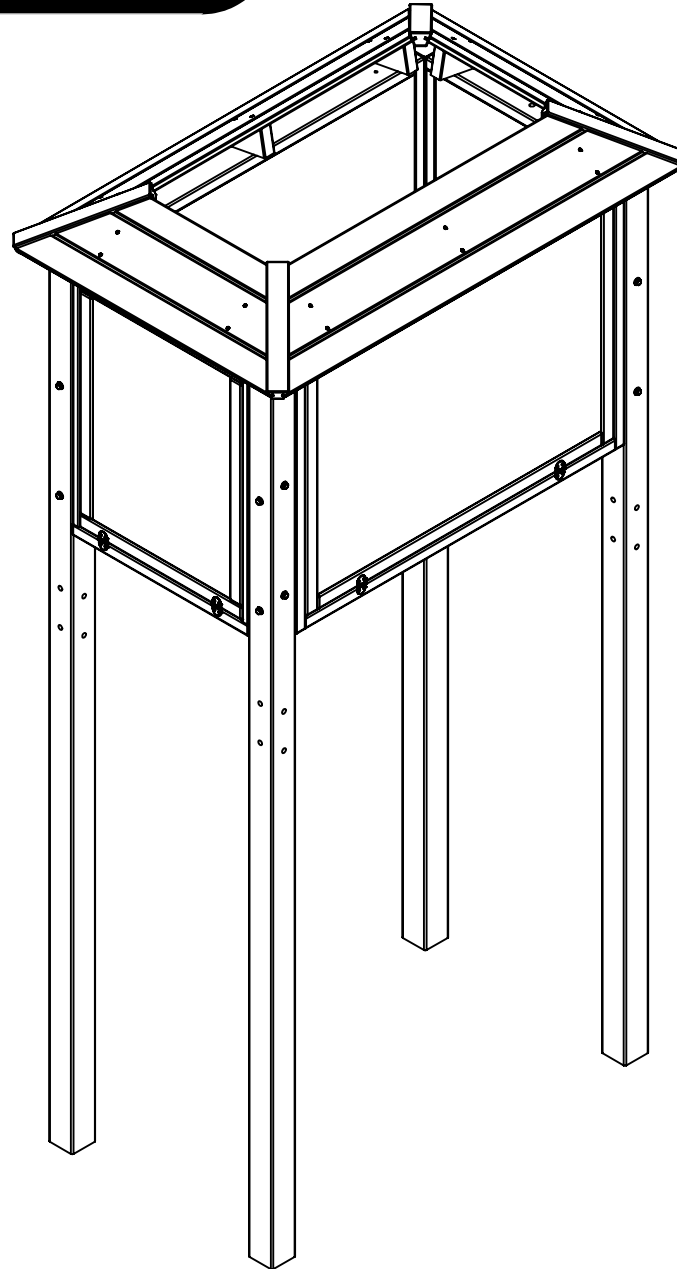

# FOUR SIDED KIOSK INGROUND MOUNT INSTRUCTIONS

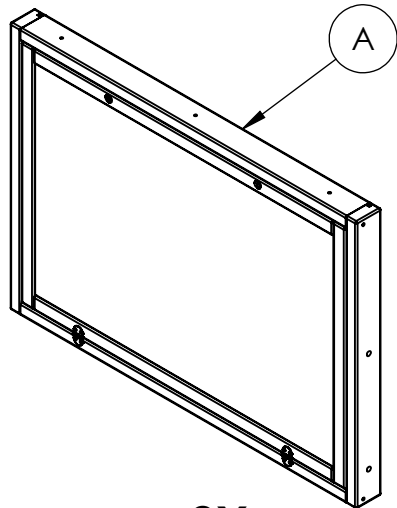

**2X**

Large Horizontal Message Center  
AMC-A0049

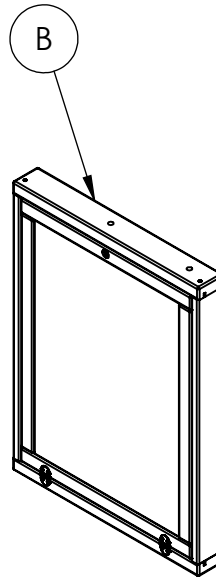

**2X**

Medium Vertical Message  
Center  
AMC-A0046

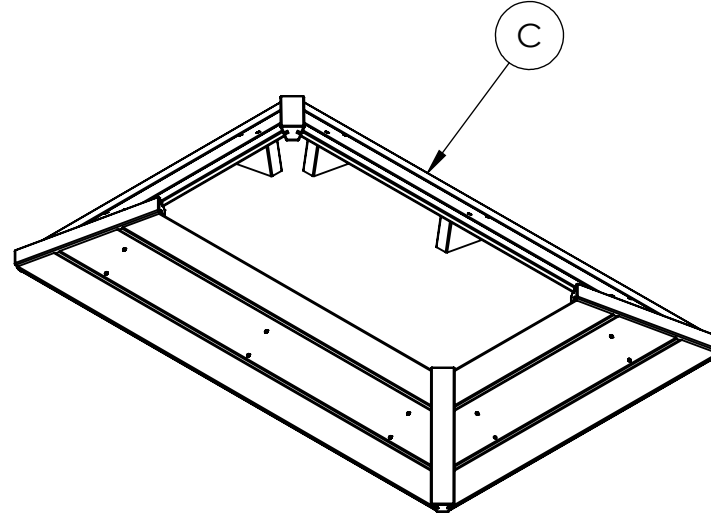

**1X**

Roof Assembly  
AMC-A0081

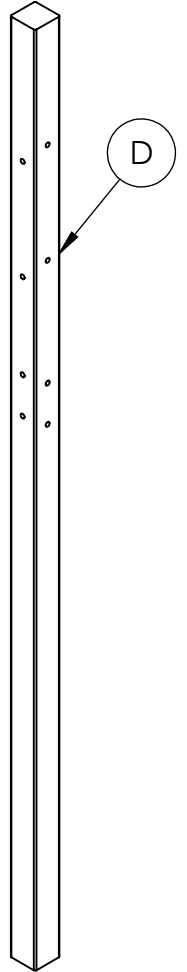

**4X**

Posts  
(Shown with holes  
for literature rack)  
AMC-P0249

## REQUIRED TOOLS (NOT INCLUDED)

- 1 - 7/16" SOCKET
- 1 - 9/16" WRENCH
- 1 - 9/16" SOCKET
- 1 - SCREW GUN
- 1 - LEVEL

## OTHER REQUIRED MATERIALS FOR INGROUND MOUNTING (NOT INCLUDED)

- 2 - 80lb BAG OF SAKCRETE
- 1 - POST HOLE DIGGER
- GUIDE WIRES
- A FRIEND TO HELP

**COMPONENTS &  
TOOLS REQUIRED  
FOR ASSEMBLY**

**1/8**

# FOUR SIDED KIOSK INGROUND MOUNT INSTRUCTIONS



**8X**  
3/8" X 6.5" Hex Head Bolt

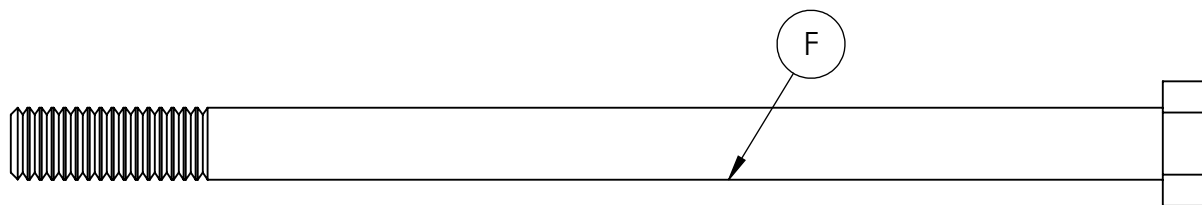

**8X**  
3/8" X 6" Hex Head Bolt

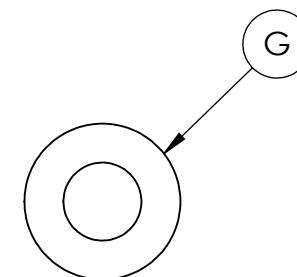

**32X**  
3/8" Flat Washer

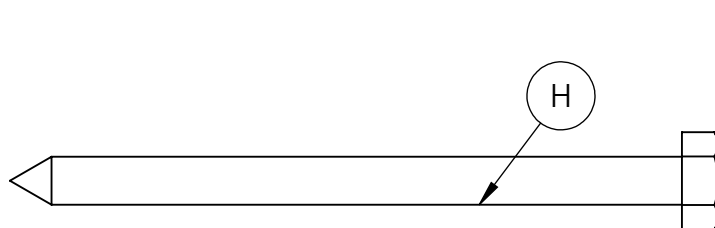

**10X**  
1/4" X 3-1/2" Lag Screw

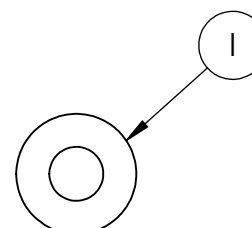

**10X**  
1/4" Flat Washer

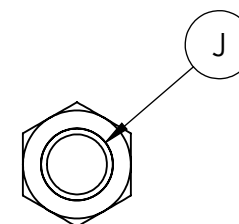

**16X**  
3/8" Hex Nut

# FOUR SIDED KIOSK INGROUND MOUNT INSTRUCTIONS

## STEP 1

- Lay the horizontal message center (A) on the ground
- Put end post (D) on the side of message center (A) with holes lining up
- Insert (2) 6.5" hex head bolts (E) with washers (G) through the post and message center and secure on the inside of the message center with washers (G) and hex nuts (J)
- Repeat for the other post and the other horizontal message center (A)

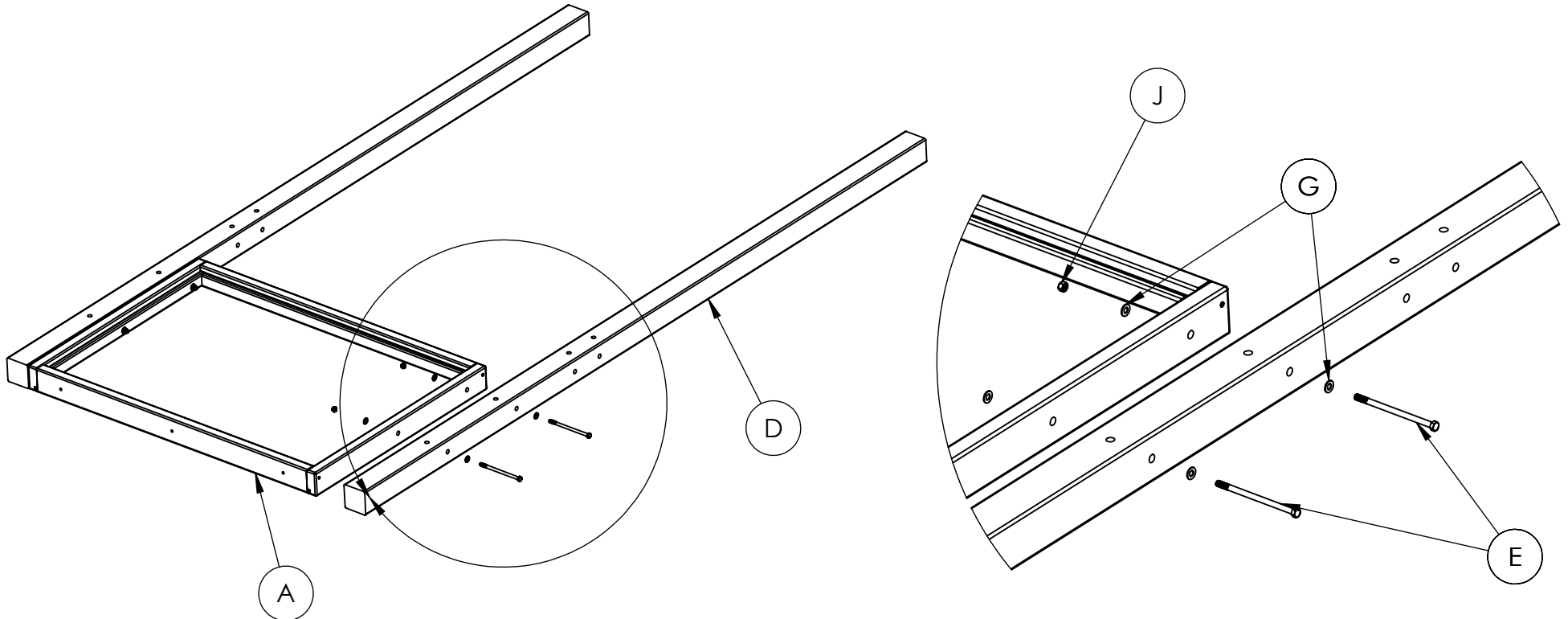

# FOUR SIDED KIOSK INGROUND MOUNT INSTRUCTIONS

## STEP 2-A

- Move message center assembly to desired location
- Mark the post location on the ground
- Dig four holes, approximately 10" in diameter to a depth of 36" (or to building code / frost line)

ALL DIMENSIONS ARE SHOWN IN INCHES

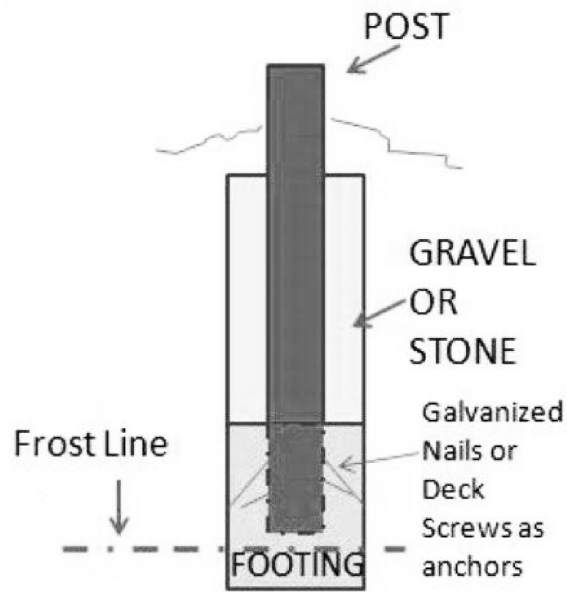
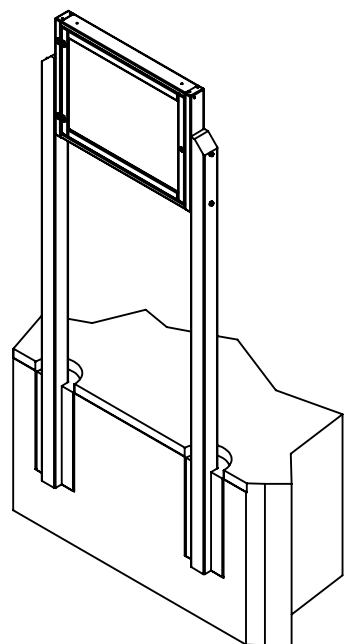
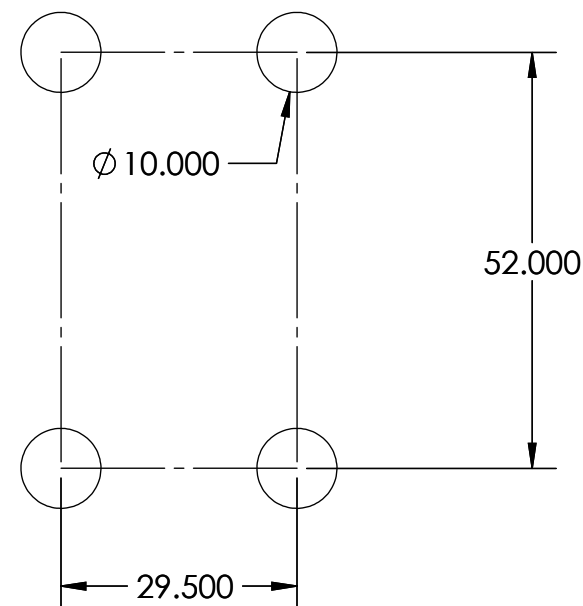

Post in Poured  
Concrete Footing

## STEP 2-B INGROUND MOUNT

- Place 1 message center assembly into the holes
- Fill with Sakcrete to a level about 4" - 6" below ground level
- Use guide wire to secure until Sakcrete is dry
- Use a level to make sure message center is square and level
- Allow Sakcrete to set before proceeding to the next step

# FOUR SIDED KIOSK INGROUND MOUNT INSTRUCTIONS

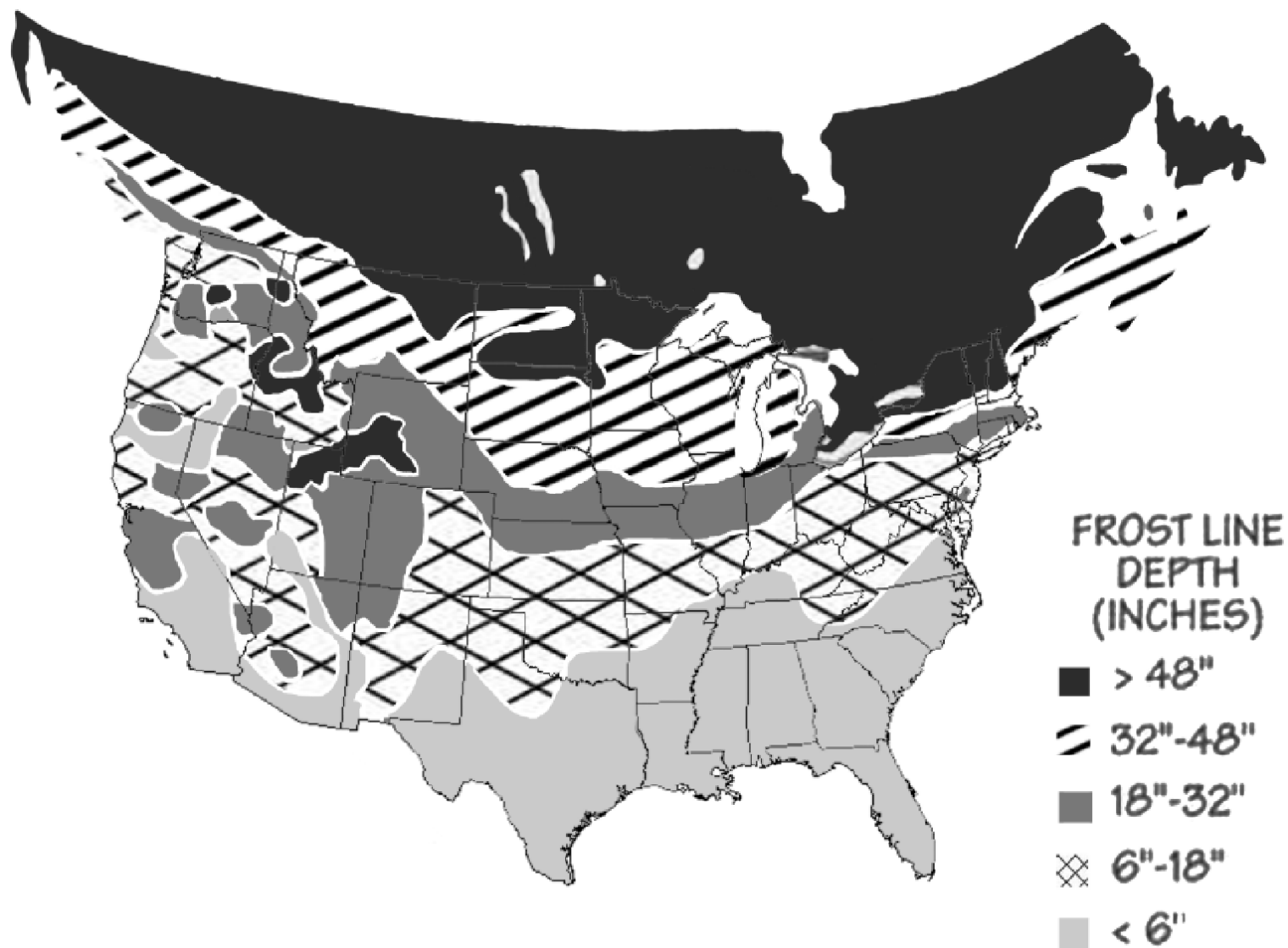

# FOUR SIDED KIOSK INGROUND MOUNT INSTRUCTIONS

## STEP 3

- With the help of another person, hold a vertical message center (B) up to the mounted horizontal assembly
- Secure the vertical message center to the post with (2) 6" hex head bolts (F) with washers (G) and (2) hex nuts (J) with washers (G)

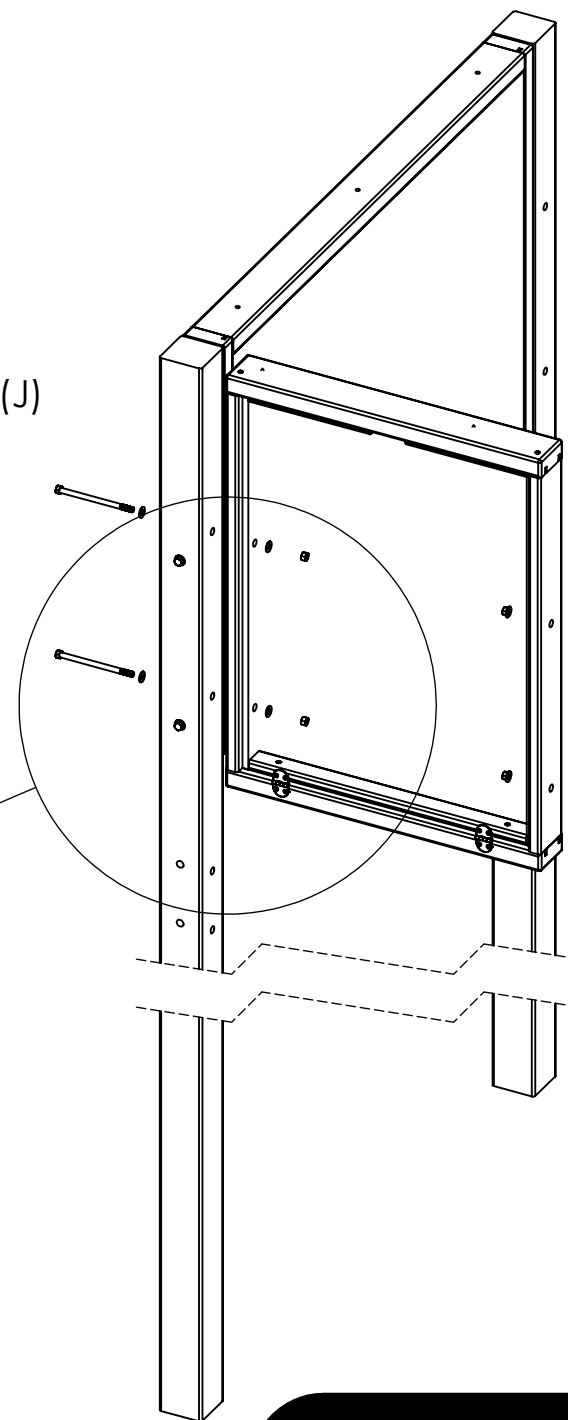
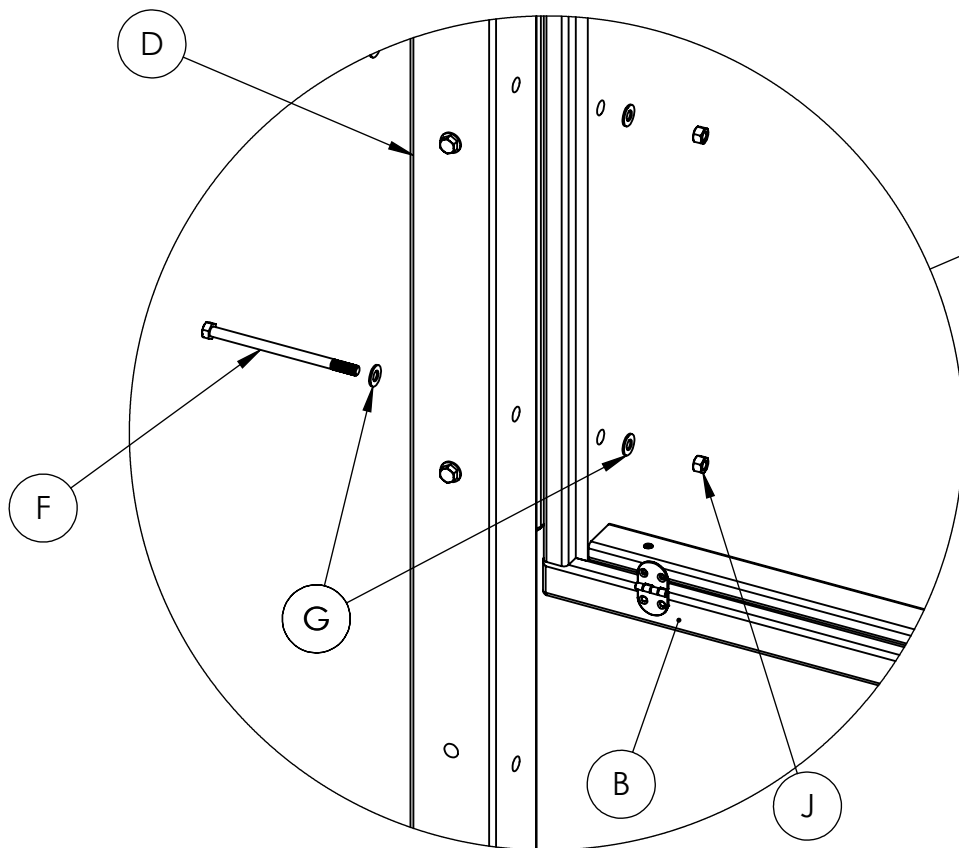

**ATTACH VERTICAL  
MESSAGE CENTER**

**6/8**

# FOUR SIDED KIOSK INGROUND MOUNT INSTRUCTIONS

## STEP 4

- Place the other horizontal message center assembly into the holes
- Secure the horizontal message center assembly to the vertical message center with (2) 6" hex head bolts (F) with washers (G) and (2) hex nuts (J) with washers (G)
- Repeat Step 3 for the remaining vertical message center
- Level the assembly and repeat Step 2-B for the remaining posts

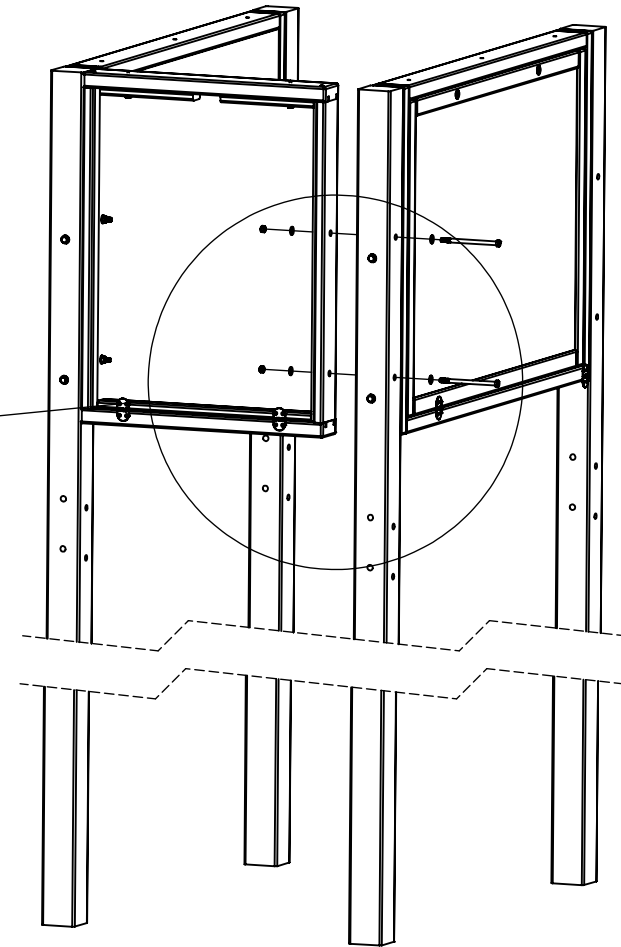
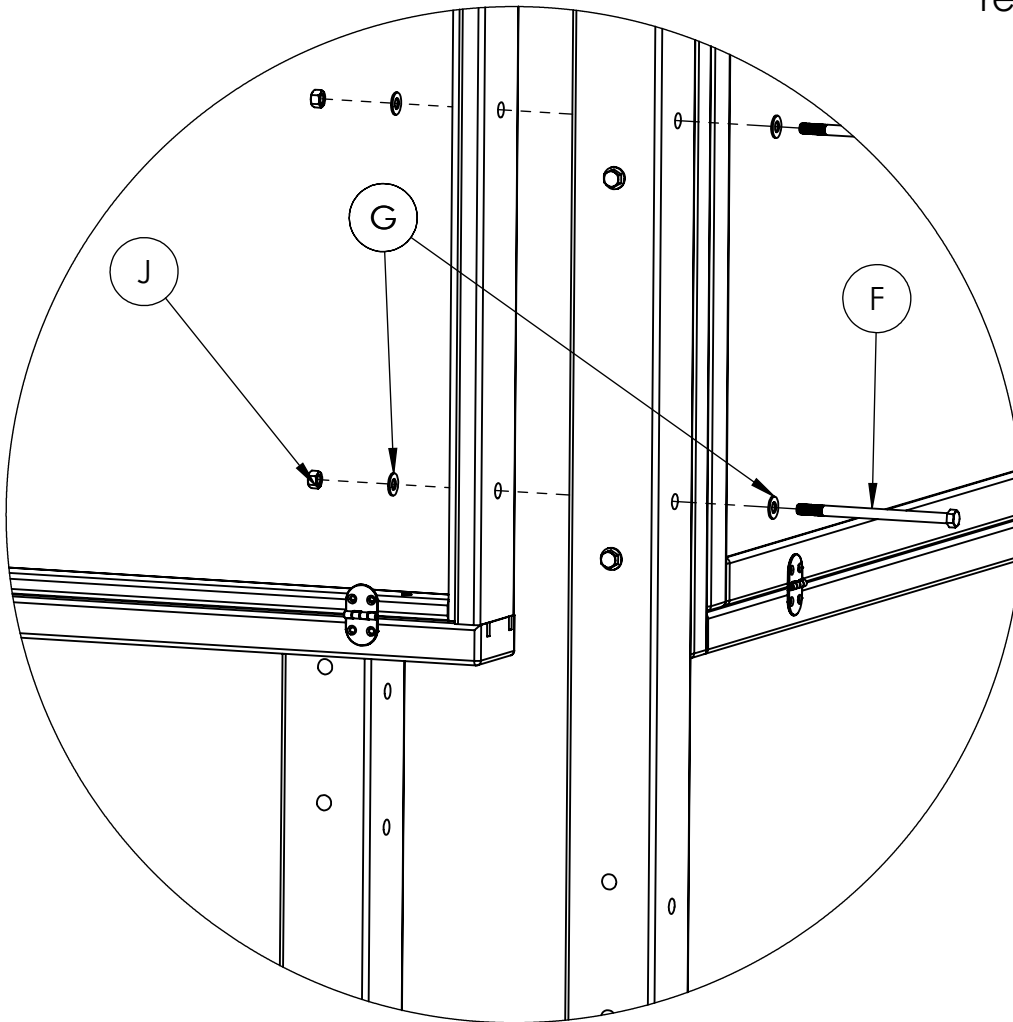

**ATTACH  
HORIZONTAL  
MESSAGE CENTER**

**7/8**



# FOUR SIDED KIOSK INGROUND MOUNT INSTRUCTIONS

## STEP 5

- Place roof assembly on top of message center assembly
- Secure with (10) 3-1/2" lag screws (H ) and flat washers (I)

## STEP 6-Remove Glass Covering

- To remove protective covering from glass, take a razor blade and trace along the frame cutting the covering
- In a corner peel back covering using the point of the blade
- Pull covering off of glass
- Repeat for other side of glass

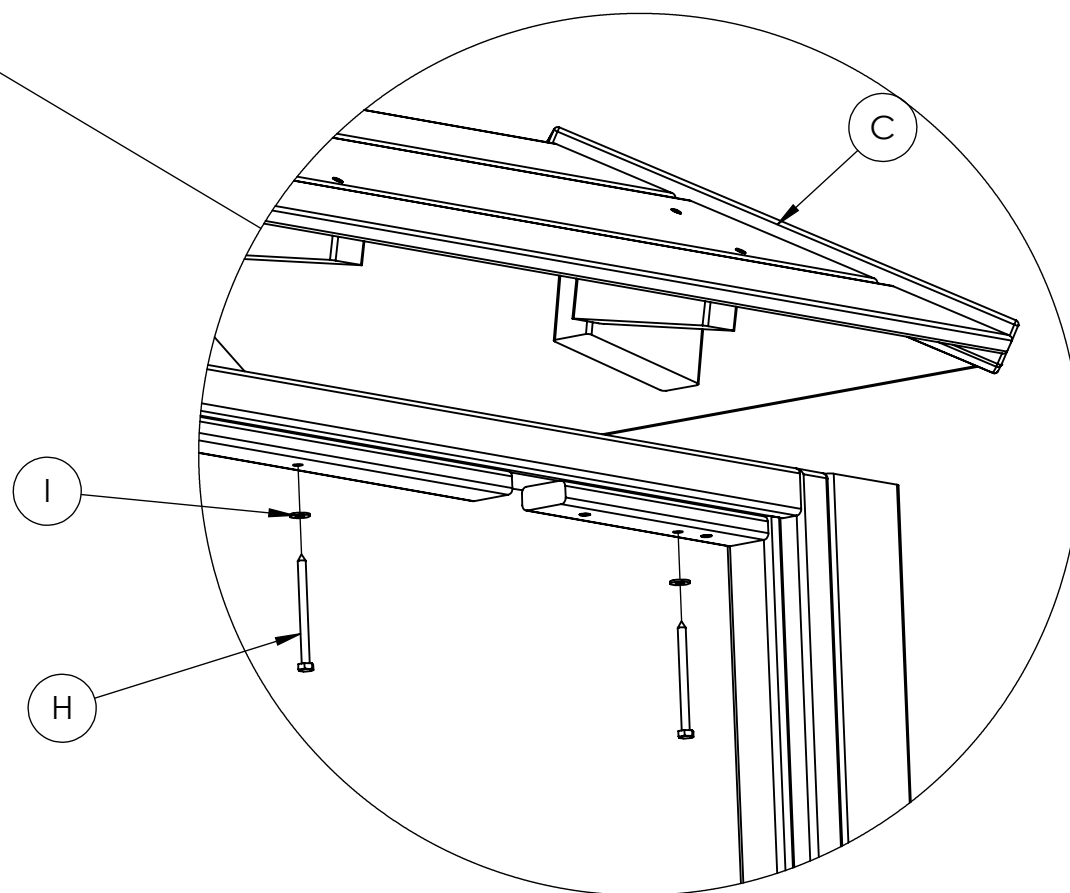
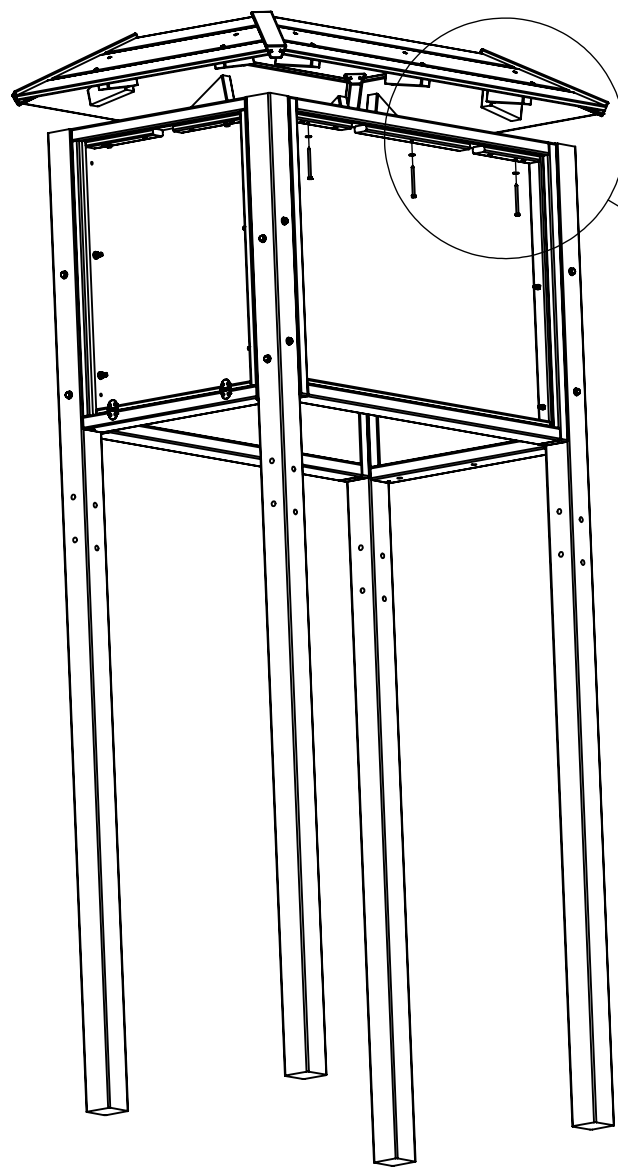

# FOUR SIDED KIOSK INGROUND MOUNT

ALL DIMENSIONS ARE SHOWN IN INCHES

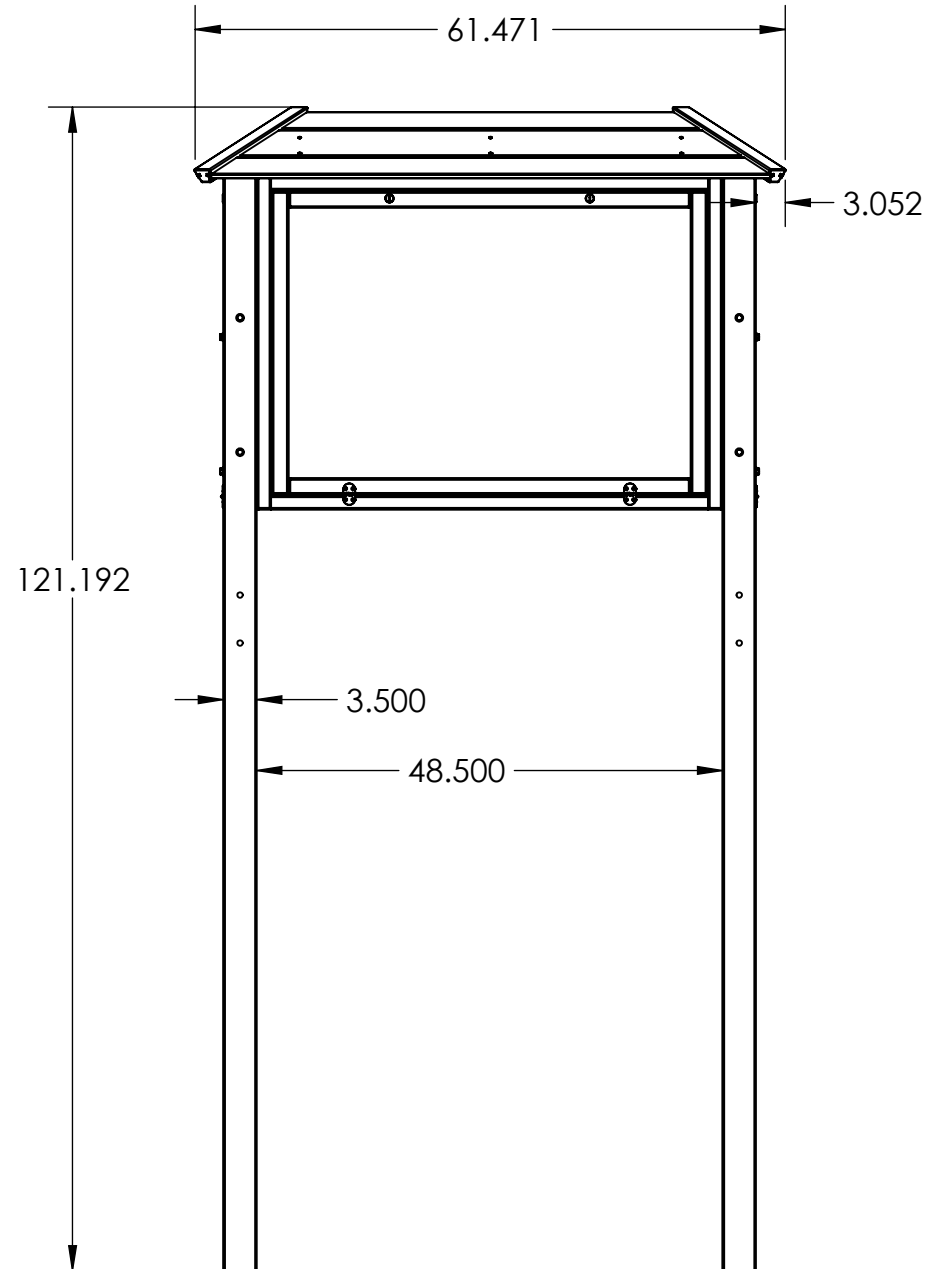
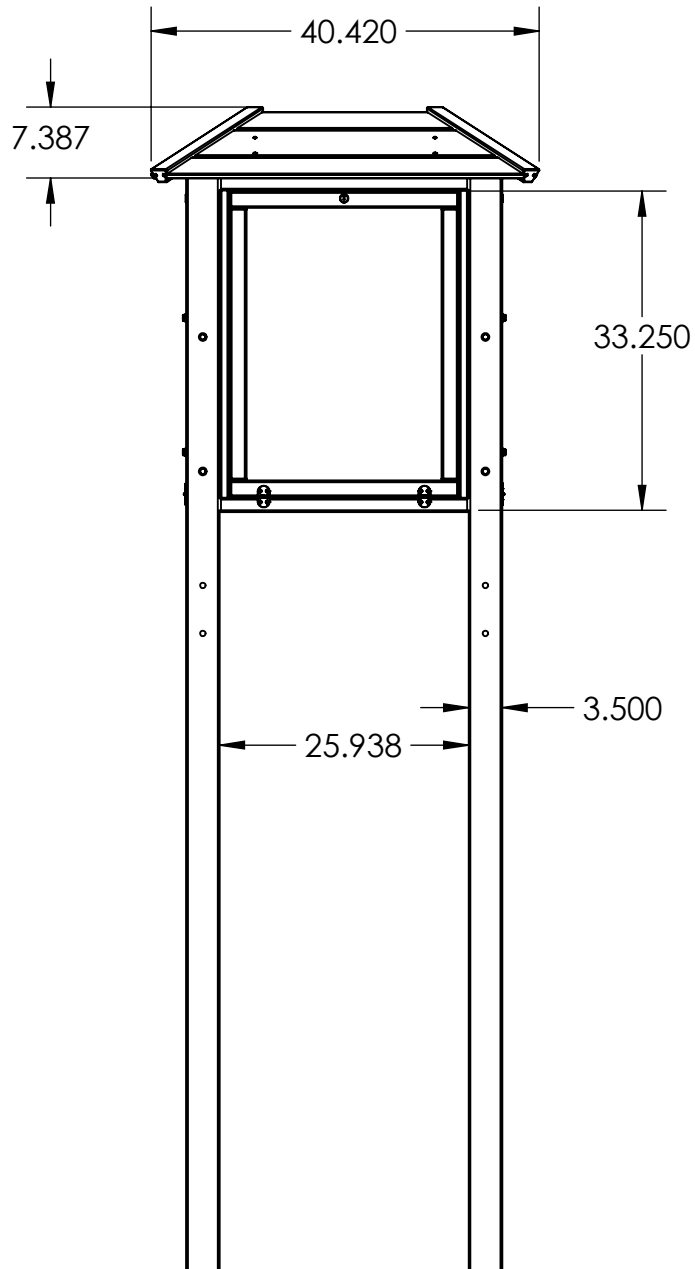

# FOUR SIDED KIOSK INGROUND MOUNT

ALL DIMENSIONS ARE SHOWN IN INCHES

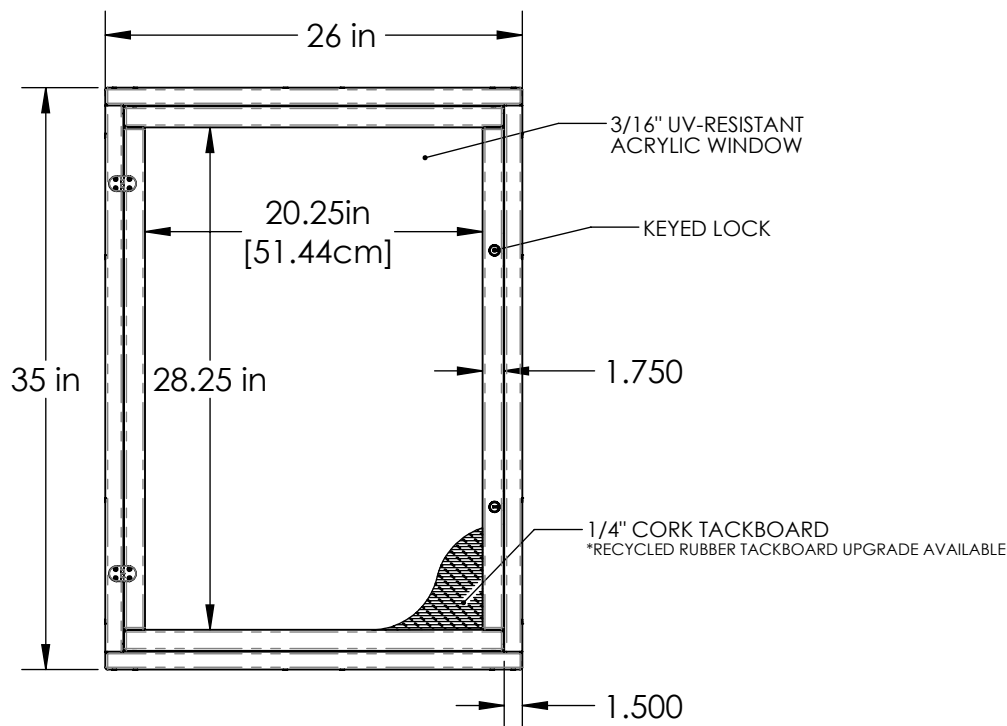

1 MESSAGE CENTER DETAILS

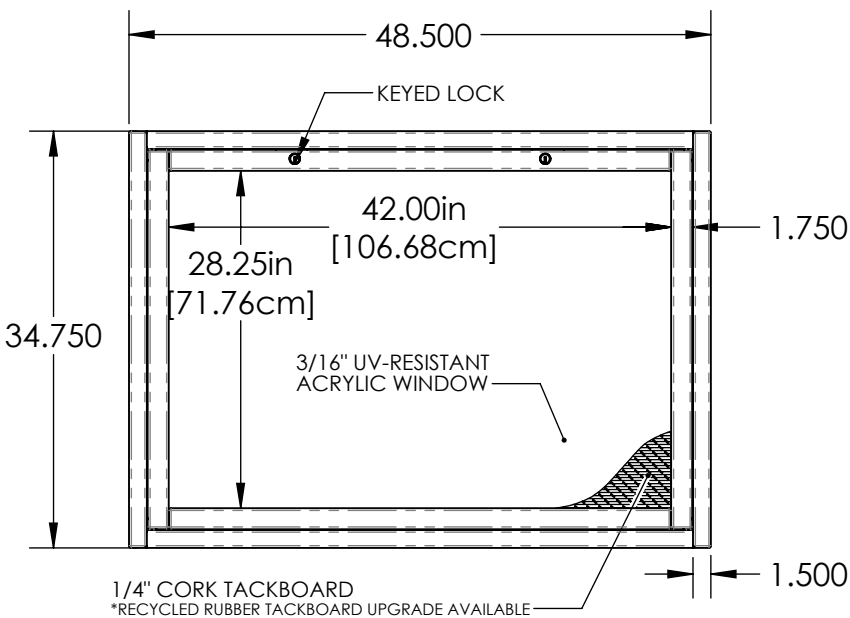

2 MESSAGE CENTER DETAILS

HARDWARE: STAINLESS STEEL  
MATERIAL: RECYCLED PLASTIC, ACRYLIC, 1/4" CORK