

3 SIDED KIOSK INSTRUCTIONS

MC3225 REV #3
2/10/2023

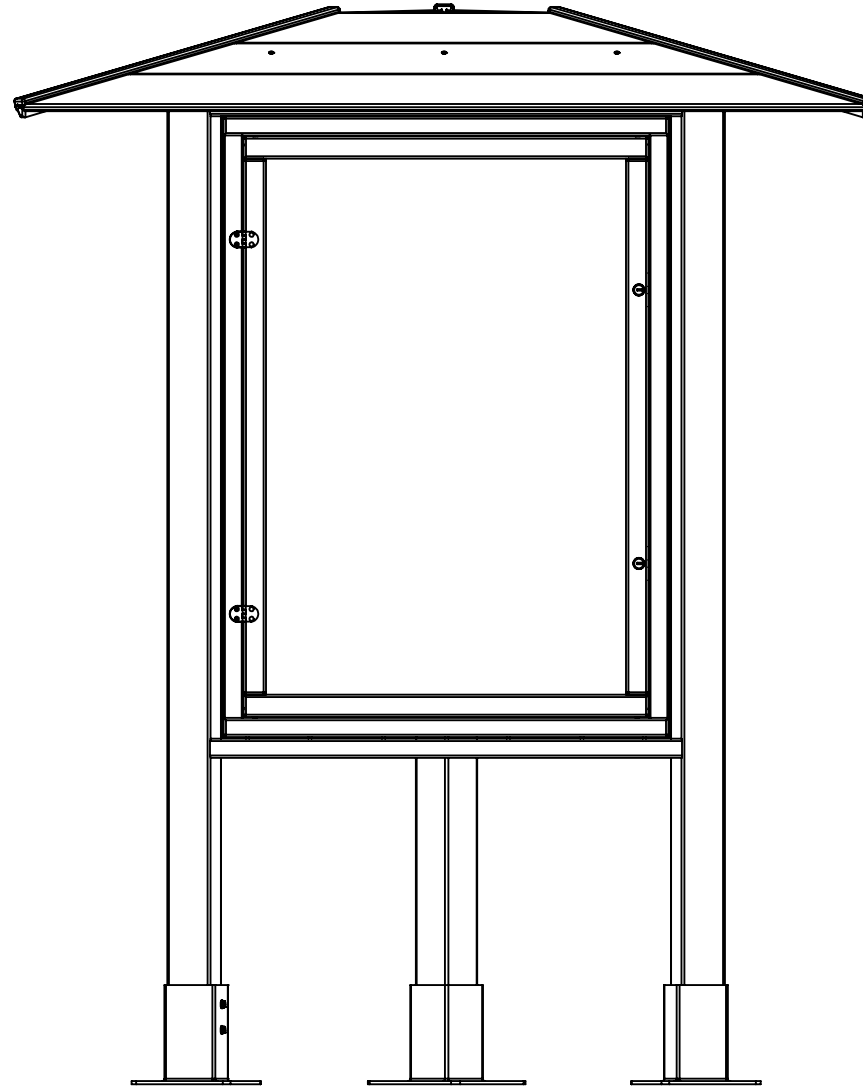

3 SIDED KIOSK INSTRUCTIONS

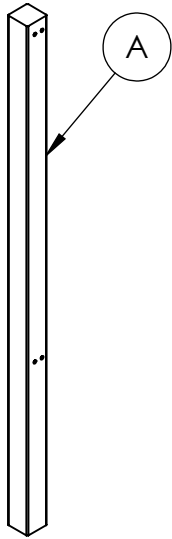

3
4 x 4 Posts
AMC-P0097

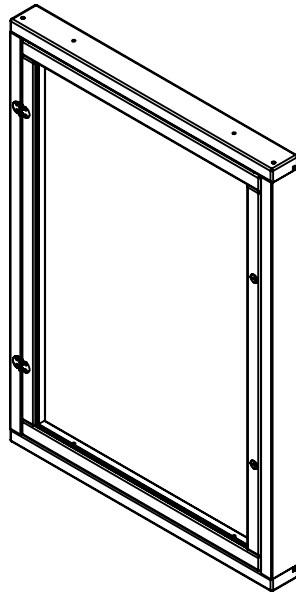

3
Message Centers
AMC-A0034

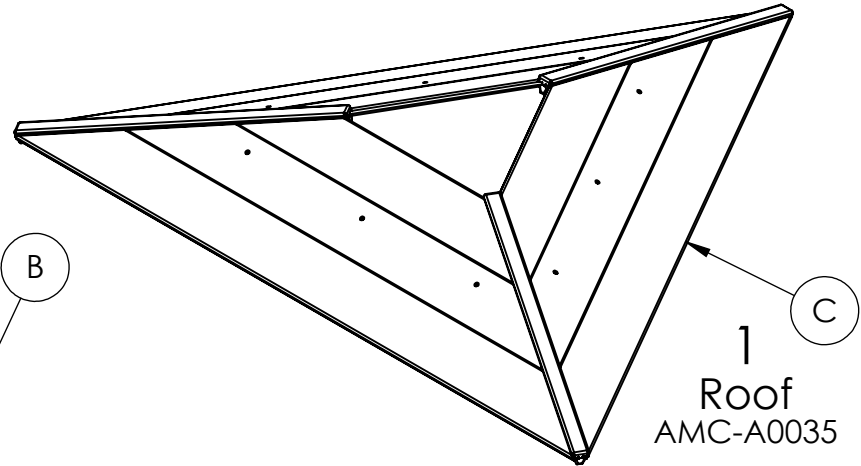

1
Roof
AMC-A0035

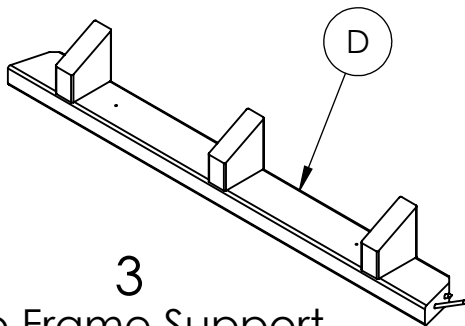

3
Top Frame Support
AMC-A0033

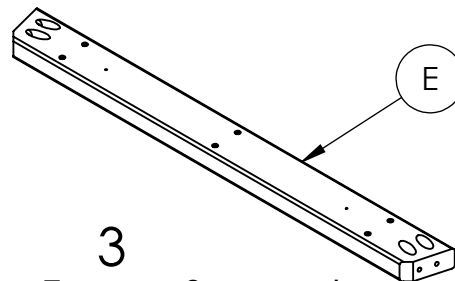

3
Bottom Frame Support
AMC-P0096

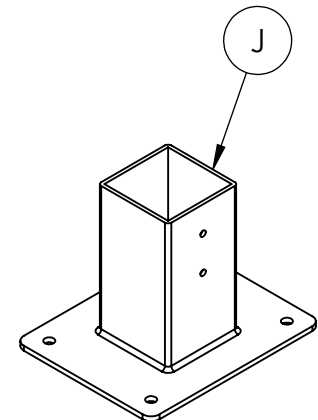

2
Mounting Bases
AMC-9185

**COMPONENTS &
TOOLS REQUIRED
FOR ASSEMBLY**

3 SIDED KIOSK INSTRUCTIONS

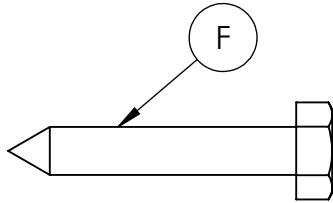

18
1/4" x 1-1/2" Lag Screws
HLAG025C150188

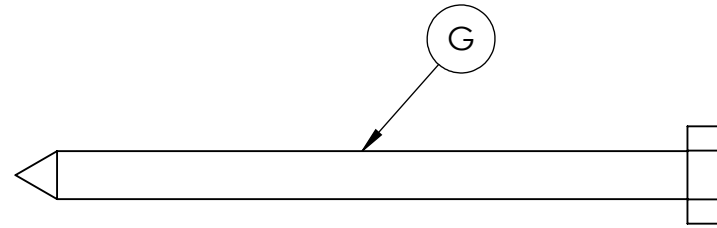

24
1/4" x 3-1/2" Lag Screws
HLAG025C350188

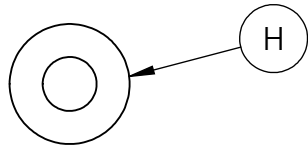

42
1/4" Flat Washers
WUSS025WAS188

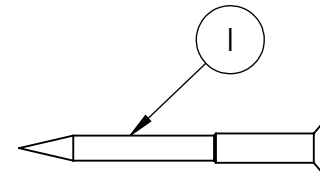

9
#8 x 1-5/8" Flat Head Screws
DSSF010C400188

REQUIRED TOOLS (NOT INCLUDED)

- 1 - 7/16" SOCKET
- 1 - SCREW GUN
- 1 - LEVEL
- 1 - #2 SQUARE DRIVE

**COMPONENTS &
TOOLS REQUIRED
FOR ASSEMBLY**

3 SIDED KIOSK INSTRUCTIONS

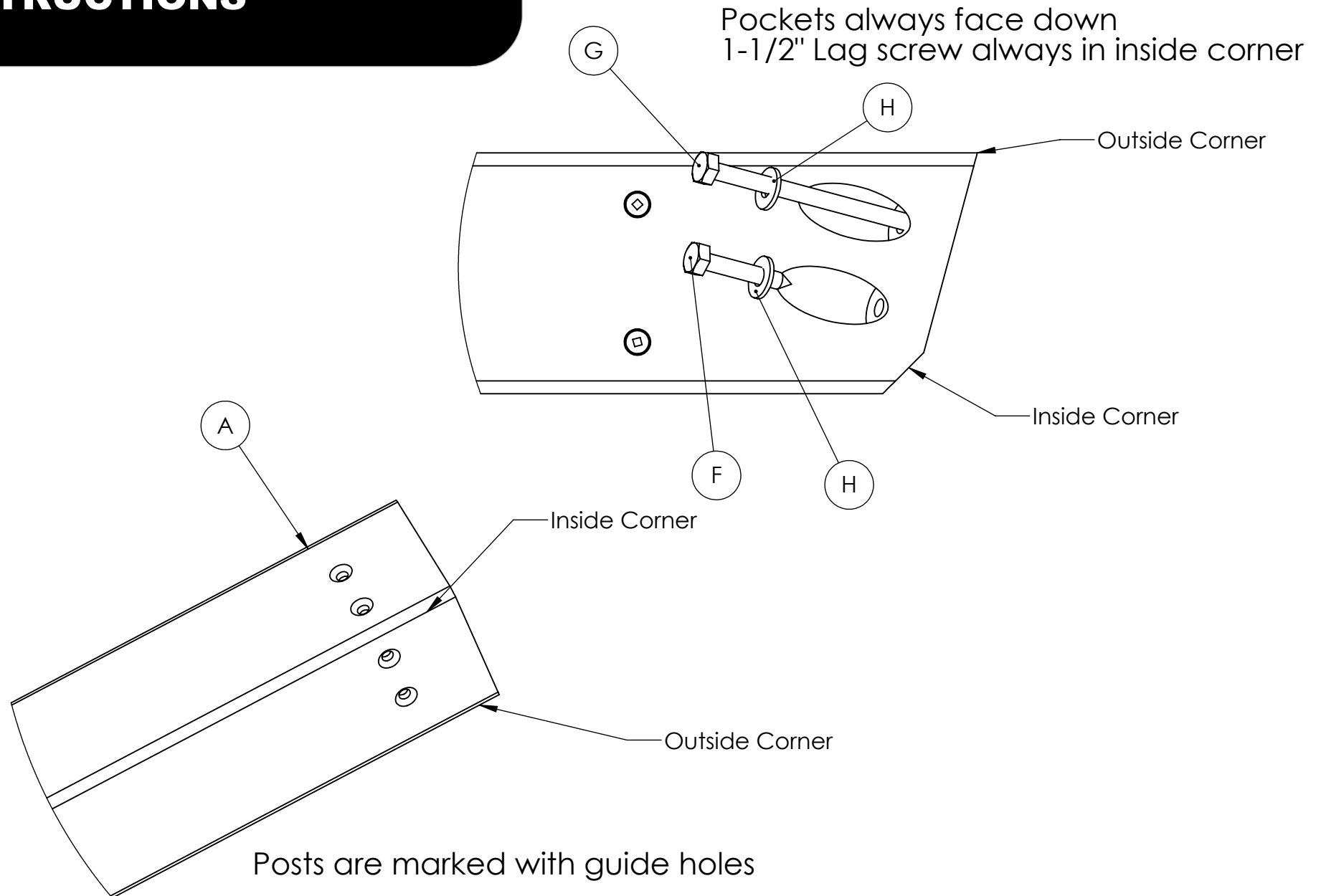

3 SIDED KIOSK INSTRUCTIONS

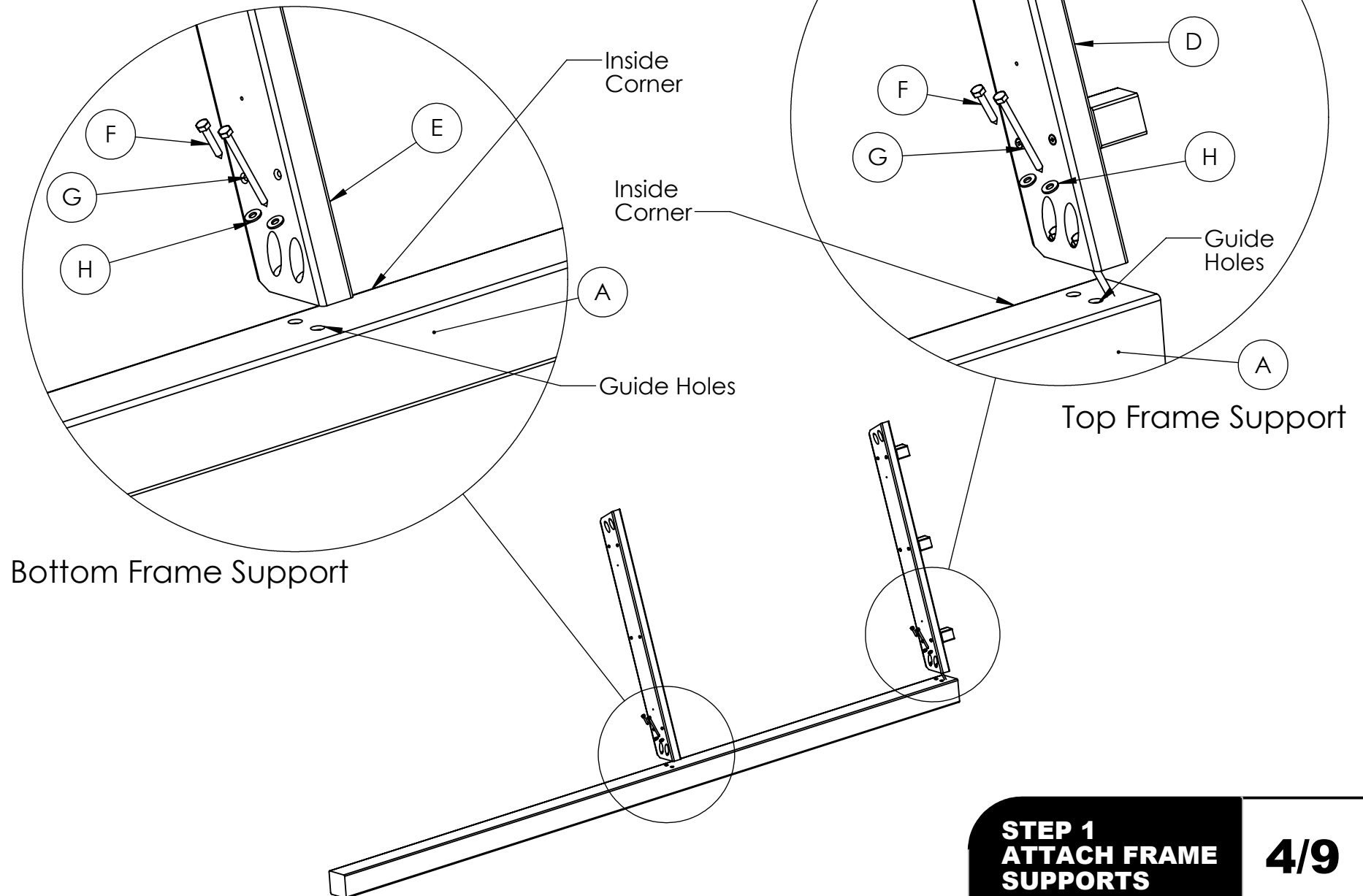

STEP 1
ATTACH FRAME
SUPPORTS

4/9

3 SIDED KIOSK INSTRUCTIONS

Attach second frame supports

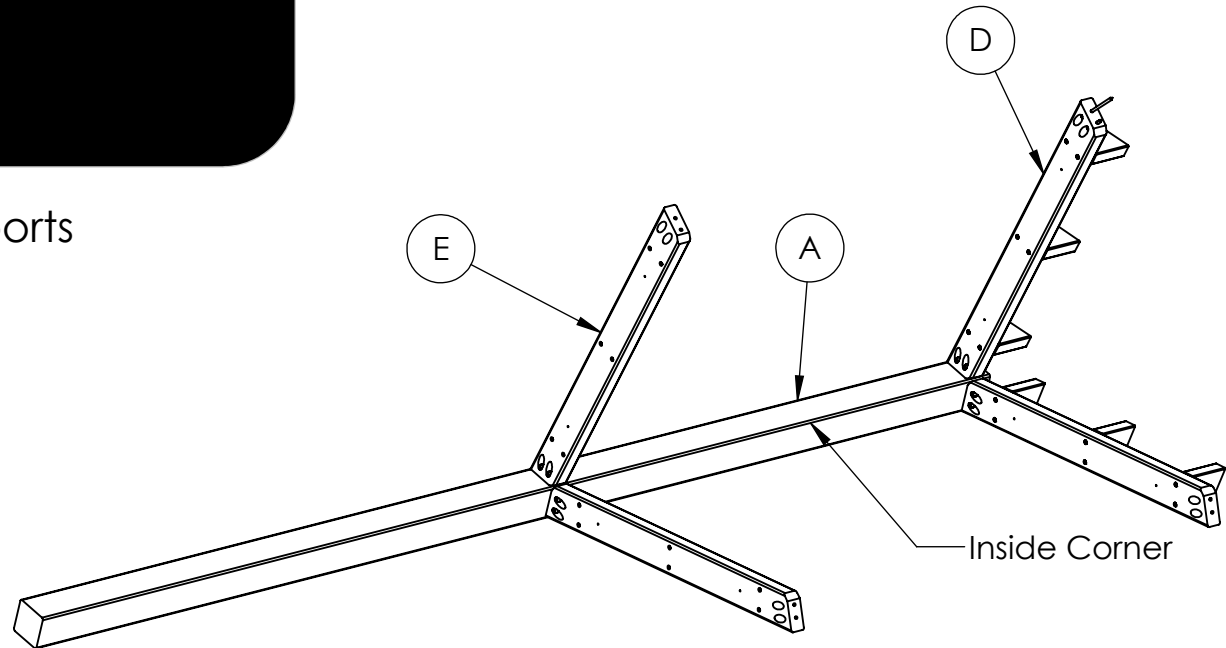

Attach second post

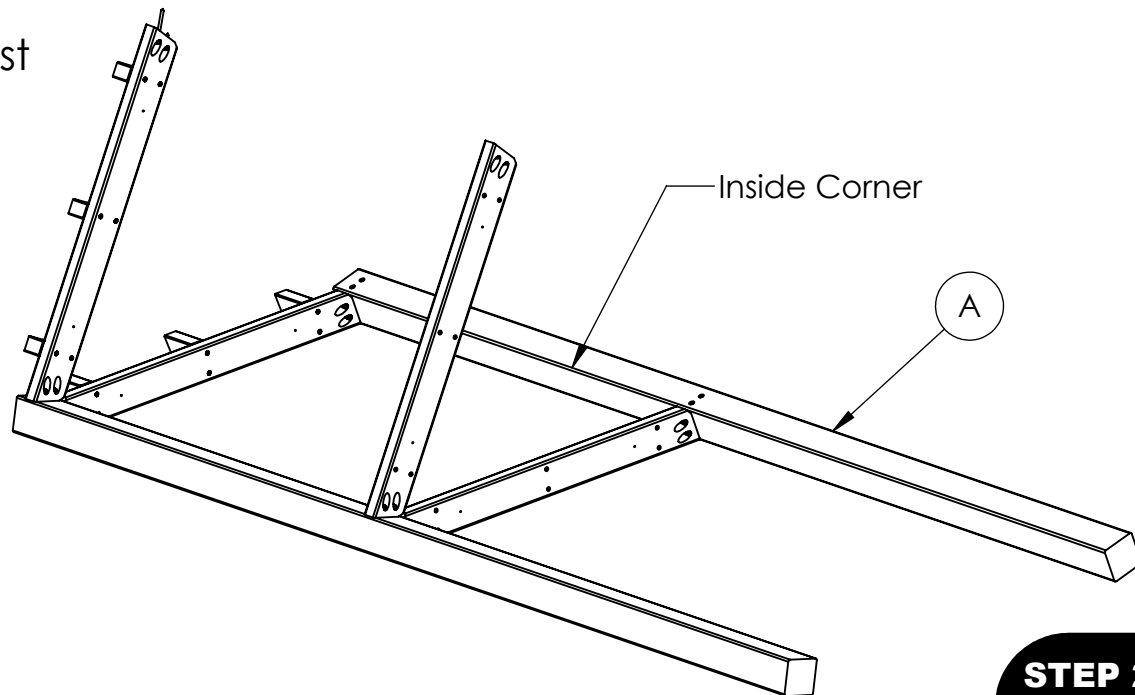

STEP 2
ATTACH SECOND
FRAME SUPPORTS

5/9

3 SIDED KIOSK INSTRUCTIONS

Attach third frame supports

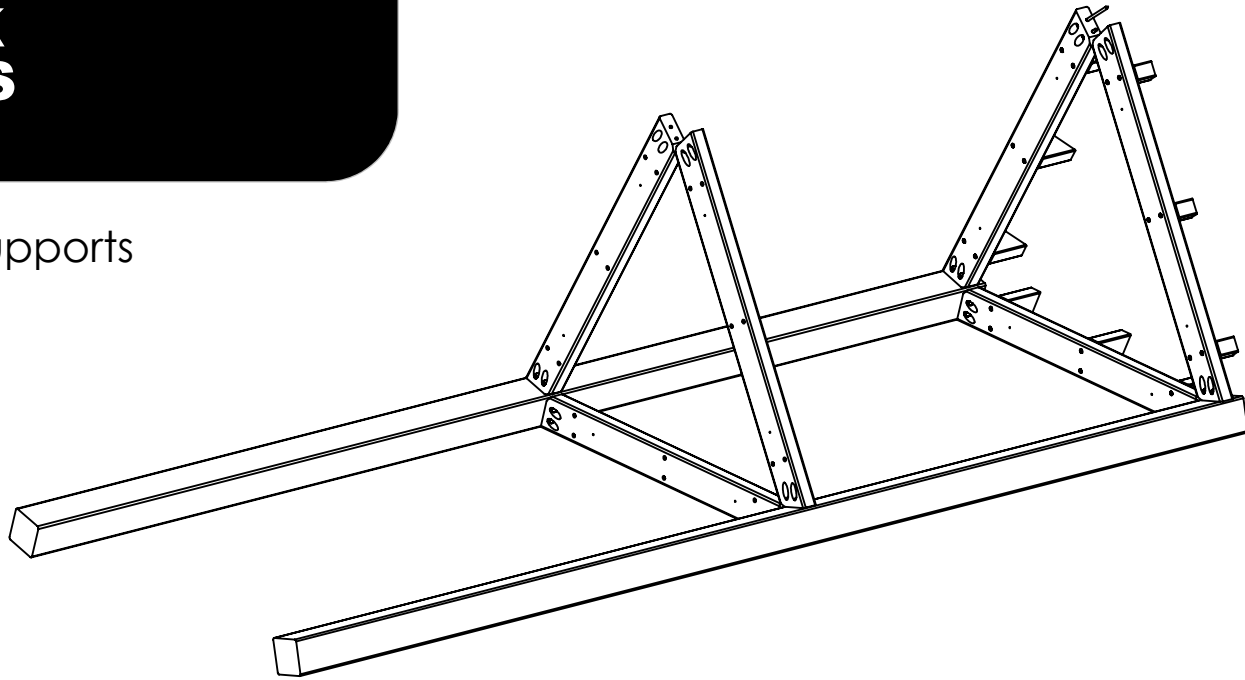

Attach third post

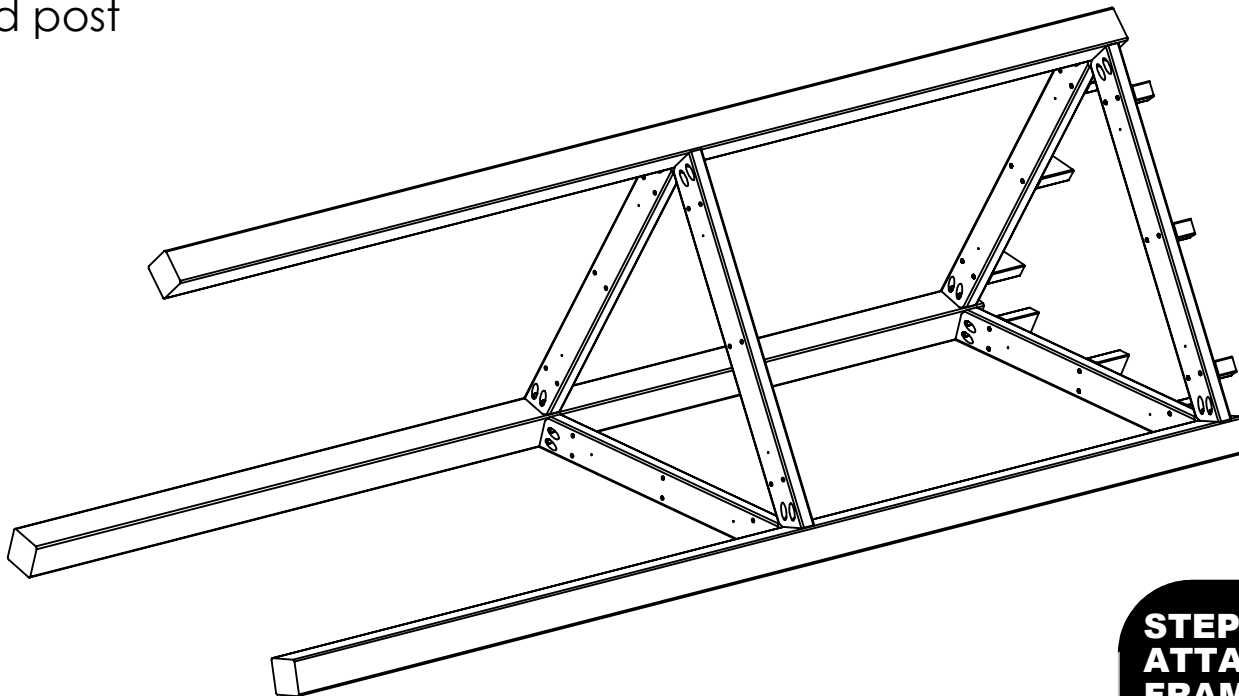

3 SIDED KIOSK INSTRUCTIONS

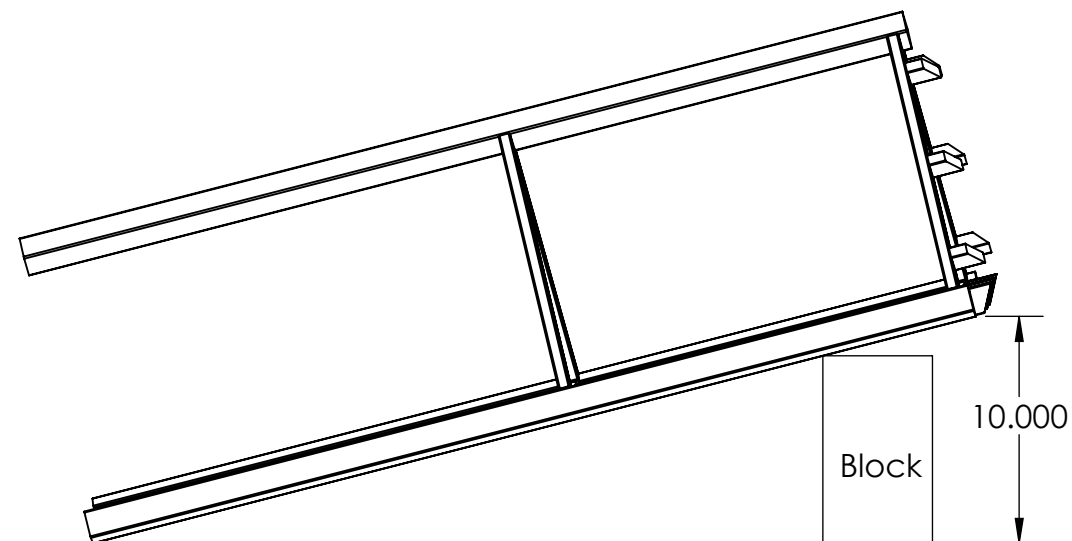

Attach Roof

- Raise the top of the frame assembly at least 10 inches off the ground to attach the roof
- Secure roof using the #8 x 1-5/8" flat head screws (I) provided

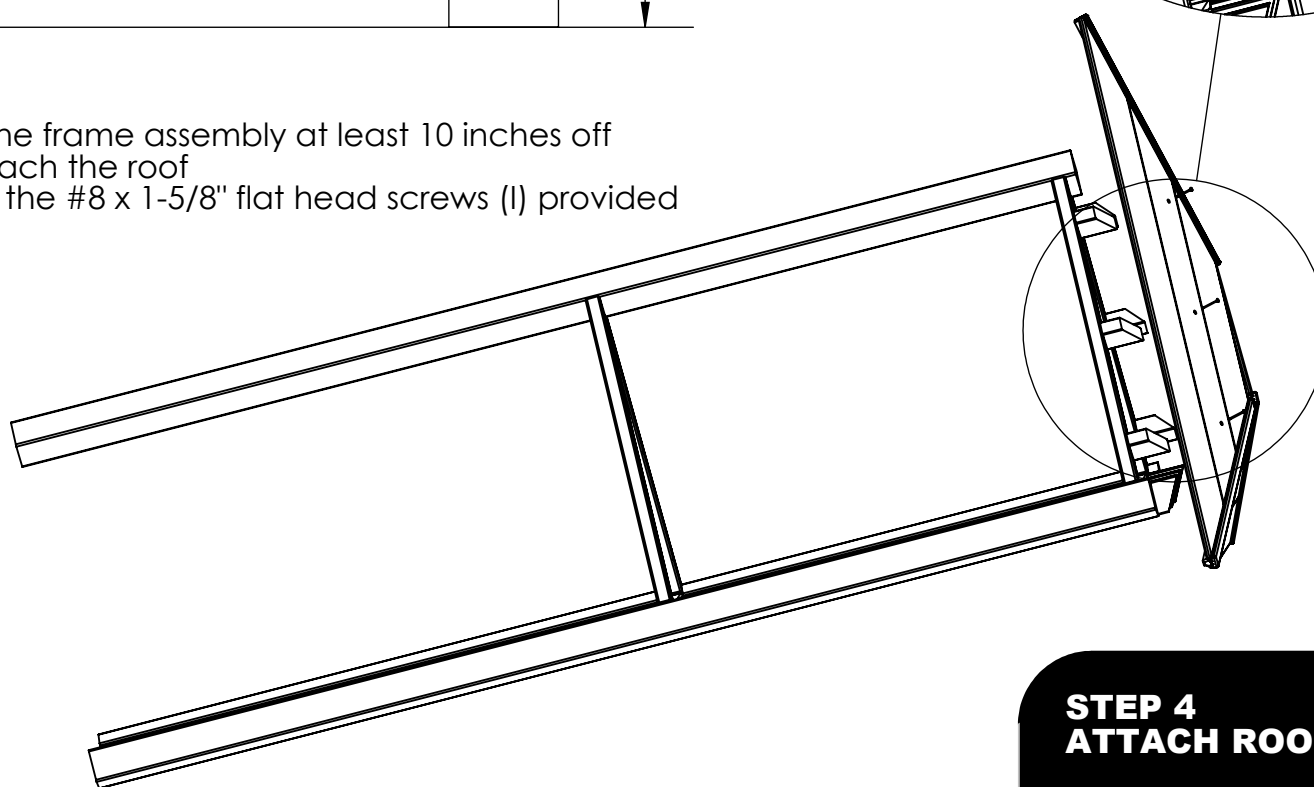

3 SIDED KIOSK INSTRUCTIONS

Surface Mount

- Place a piece of cardboard underneath the edge of the roof (C)
- Move the blocks to the base of the frame assembly
- Attach the mounting bases (J) using two 1/4" x 1-1/2" lag screws (F) and two 1/4" flat washers (H) per mounting base (J)

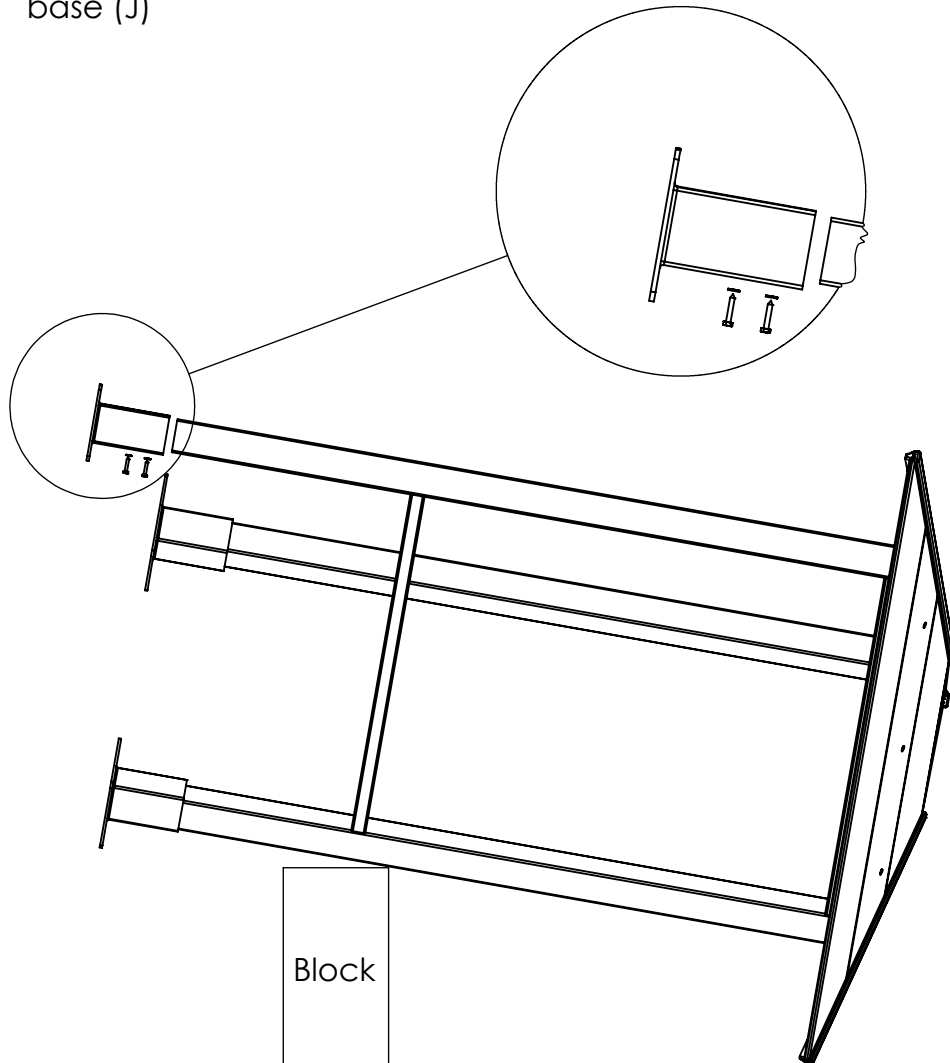

Surface Mount

- Stand the assembly upright and place in desired location
- Mark the hole locations on the ground
- Use the appropriate mounting hardware for your location and secure the frame assembly to the ground

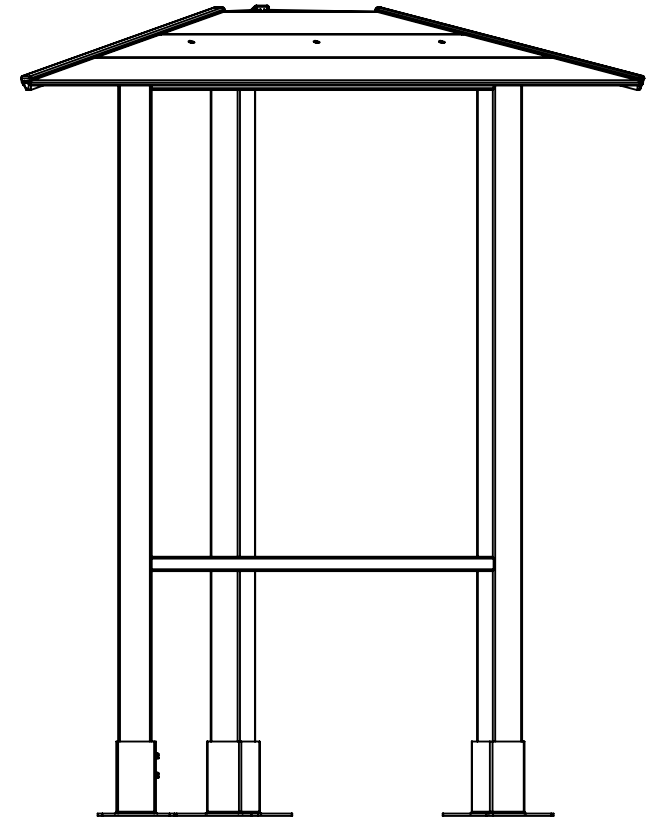

3 SIDED KIOSK INSTRUCTIONS

Attach Message Centers

- Set a message center (B) into the frame assembly
- Insert four 1/4" x 3-1/2" lag screws (G) and 1/4" flat washer (H)
- through the guide holes in the top and bottom of the message center (B)
- Tighten and repeat for the other two message centers

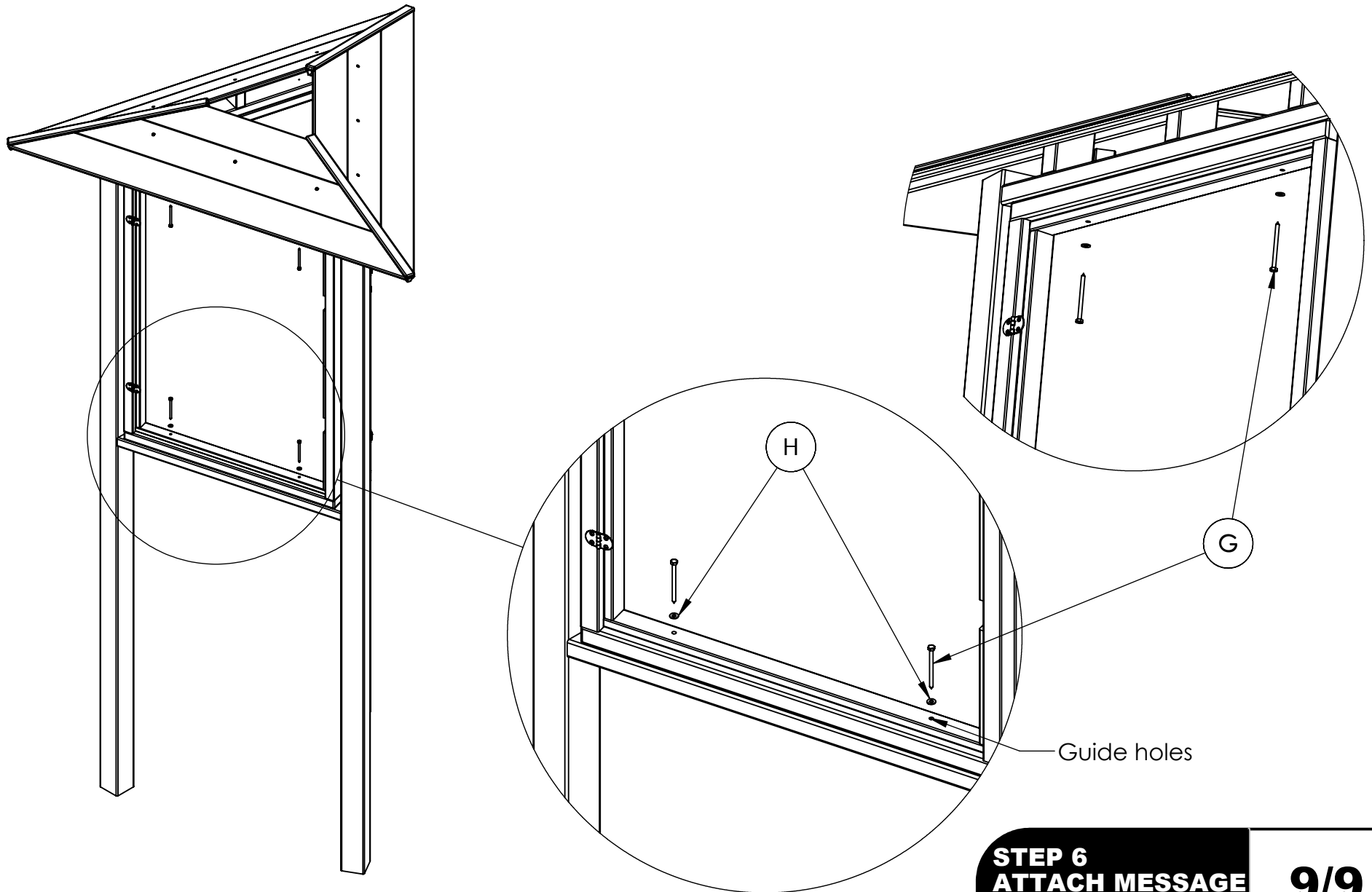

THREE-SIDED KIOSK SURFACE MOUNT

MC3225 REV #3
2/10/2023

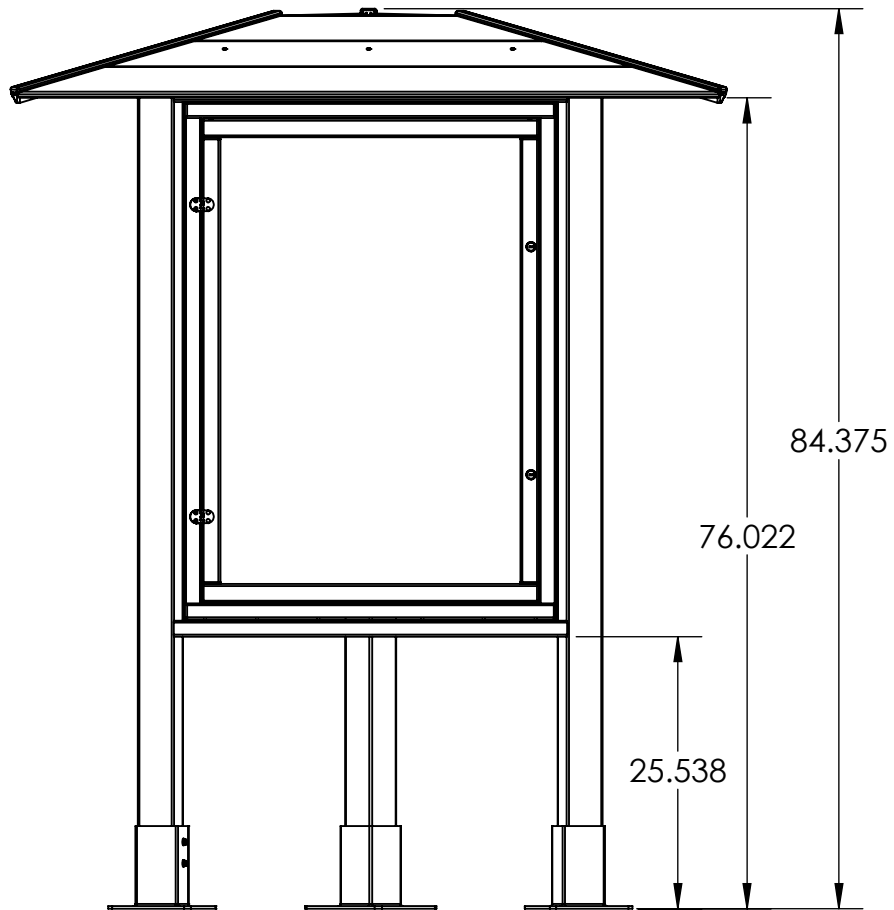

FRONT

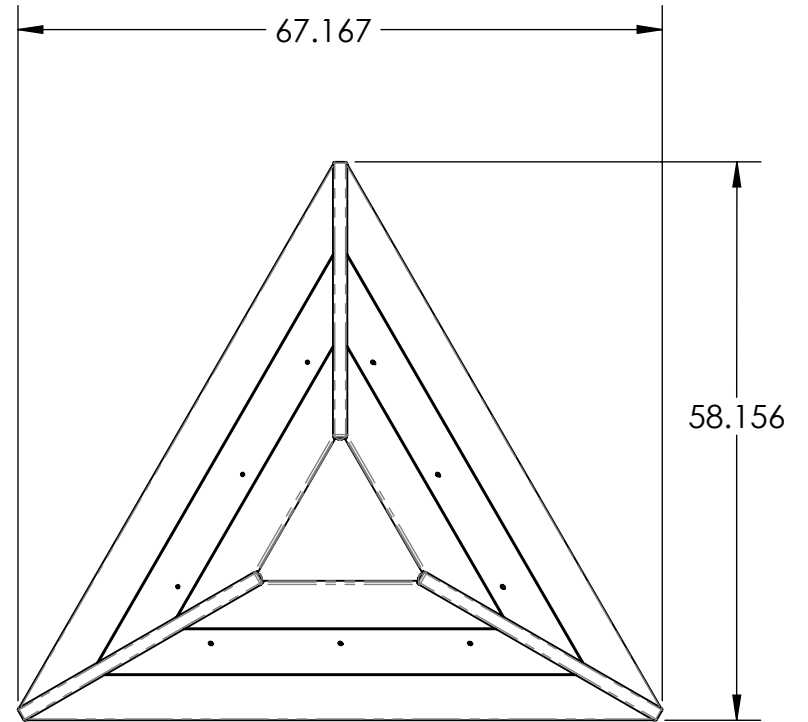

TOP

MC3225 REV #3
2/10/2023

