

# TABLE INSTRUCTIONS

CF1150 REV# 3  
9-12-2022

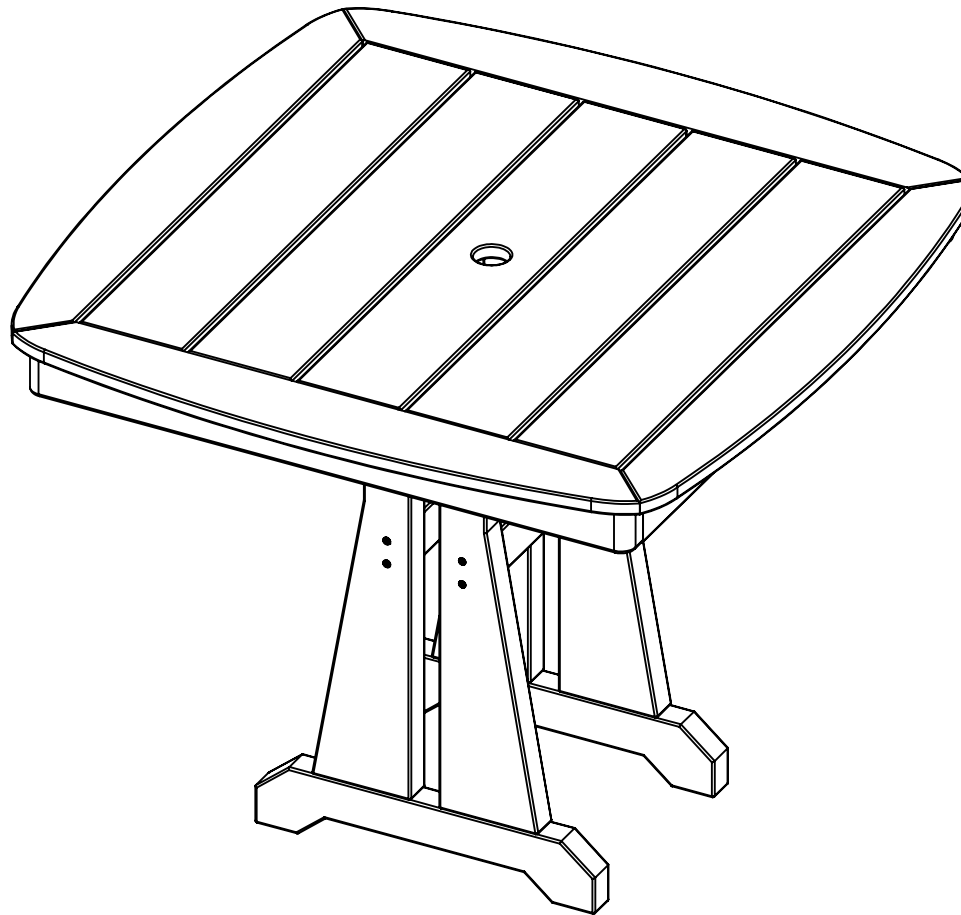

# TABLE INSTRUCTIONS

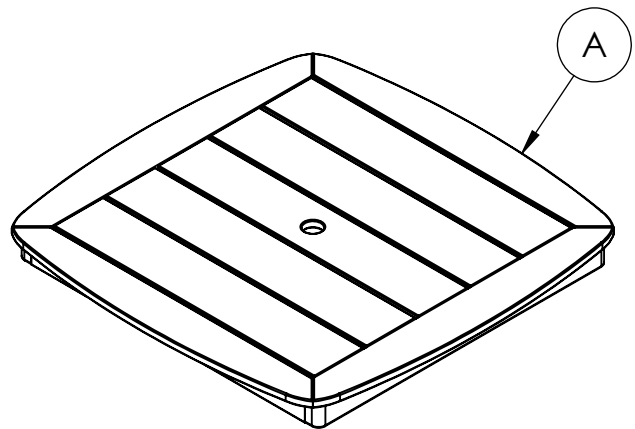

1  
Table Top Assembly

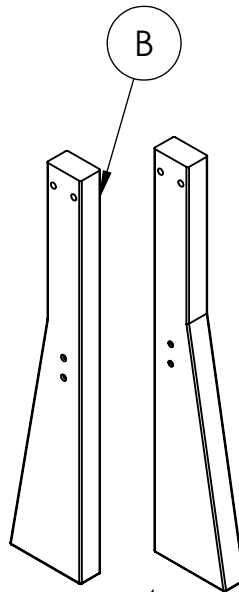

4  
Table Legs

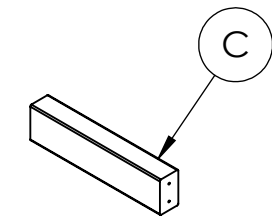

2  
Cross Braces

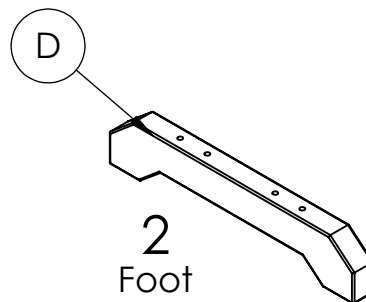

2  
Foot

## REQUIRED TOOLS (NOT INCLUDED)

- POWER DRILL
- #2 SQUARE DRIVE
- (2) 9/16 WRENCH OR SOCKET

**NOTE: IT IS IMPORTANT TO KEEP ALL  
SCREWS LOOSE DURING ASSEMBLY  
UNTIL ENTIRE TABLE IS ASSEMBLED**

## HARDWARE

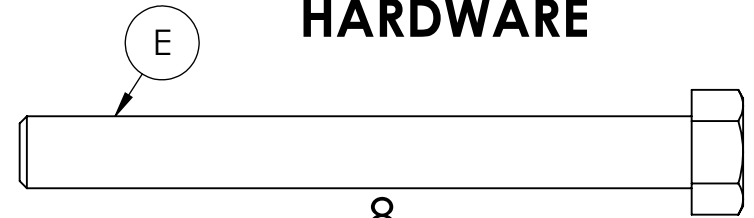

8  
3/8" x 3.5" Hex Head Bolts

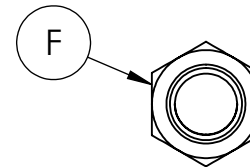

8  
3/8" Hex Nuts

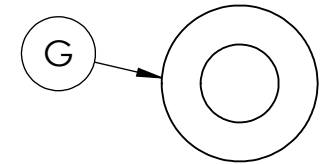

16  
3/8" Flat Washer

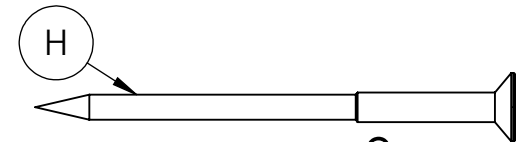

8  
#10 x 2.5 Flat Head Screw

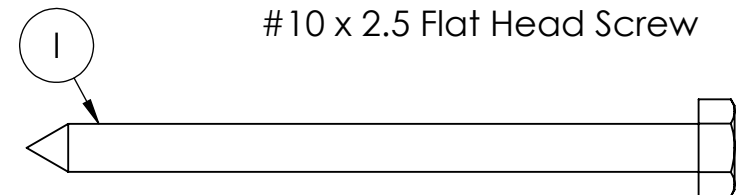

8  
1/4" x 3.5" Hex Lag Screw

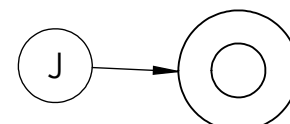

8  
1/4" Flat Washer

**HARDWARE &  
TOOLS REQUIRED  
FOR ASSEMBLY**

**2/5**

# TABLE INSTRUCTIONS

## STEP 1

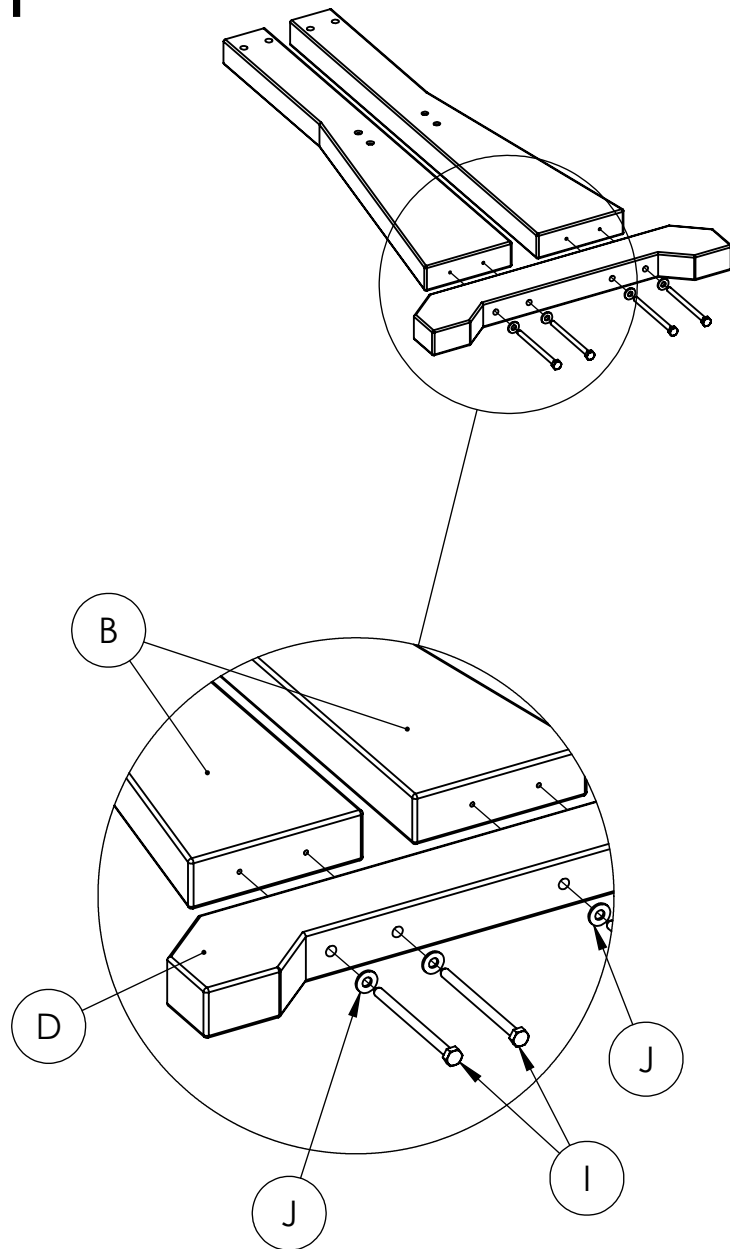

## STEP 2

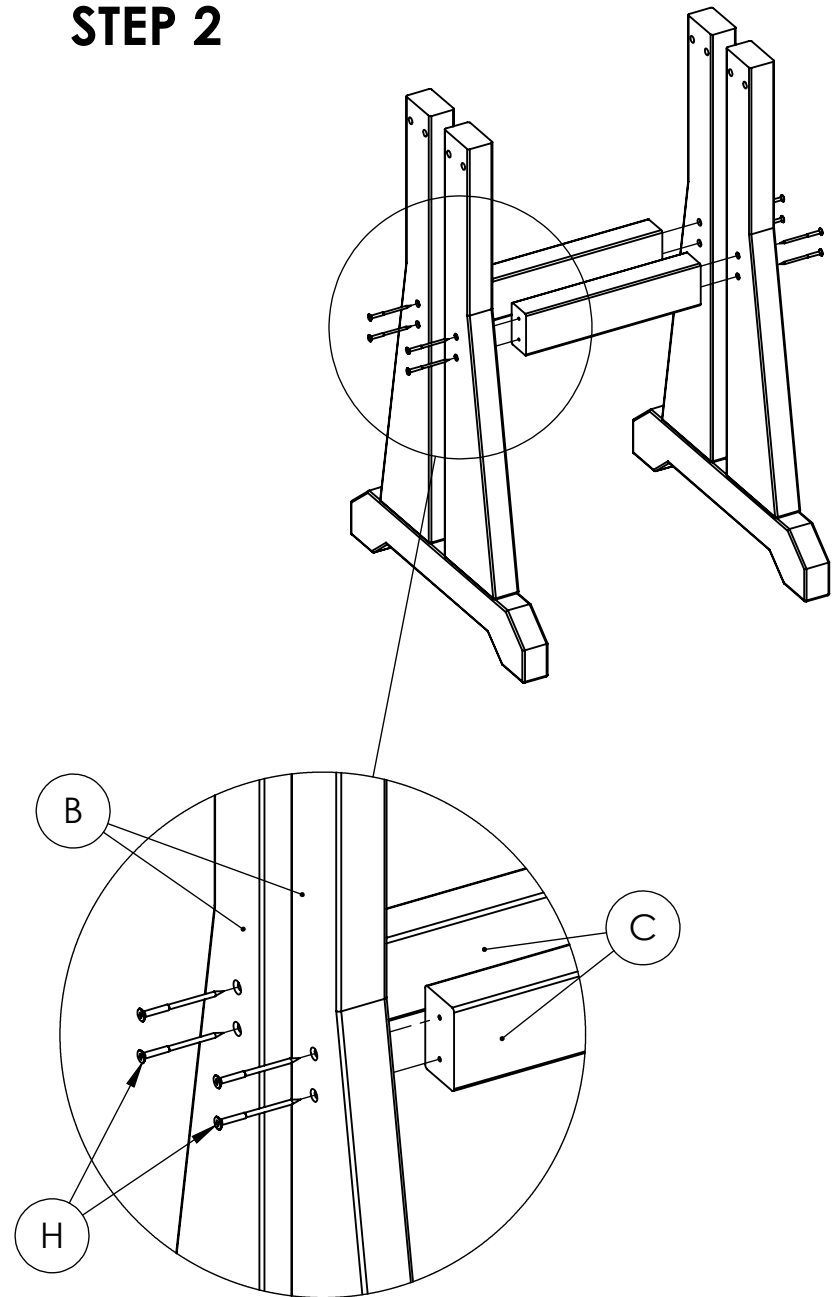

## TABLE INSTRUCTIONS

### STEP 3

- Attach leg assembly with table upside down - **leave bolts loose.**
- Flip table right side up then fully tighten all bolts.

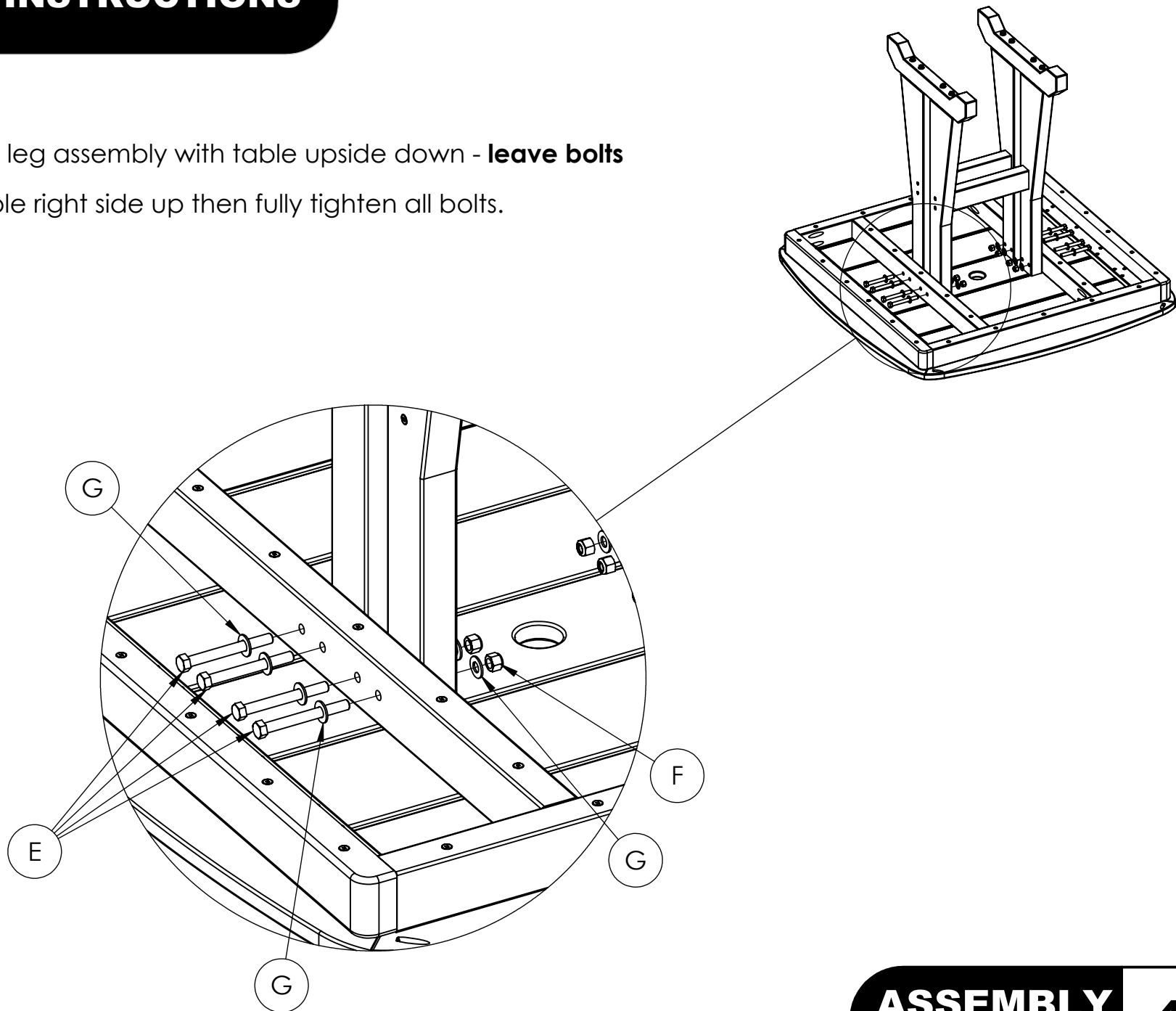

# TABLE SPECIFICATIONS

CF1150 REV# 3  
9-12-2022

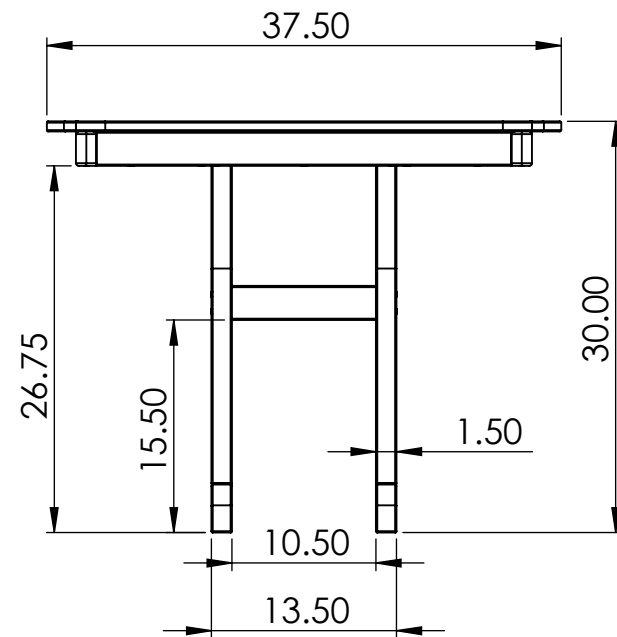
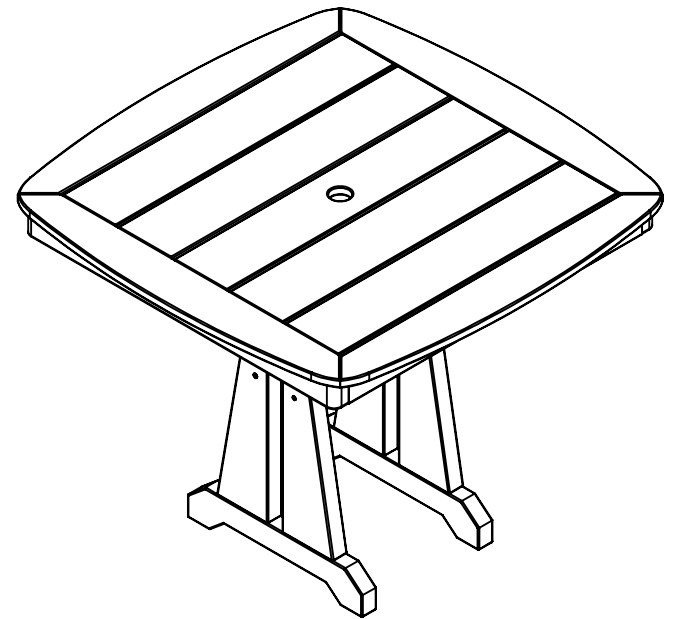
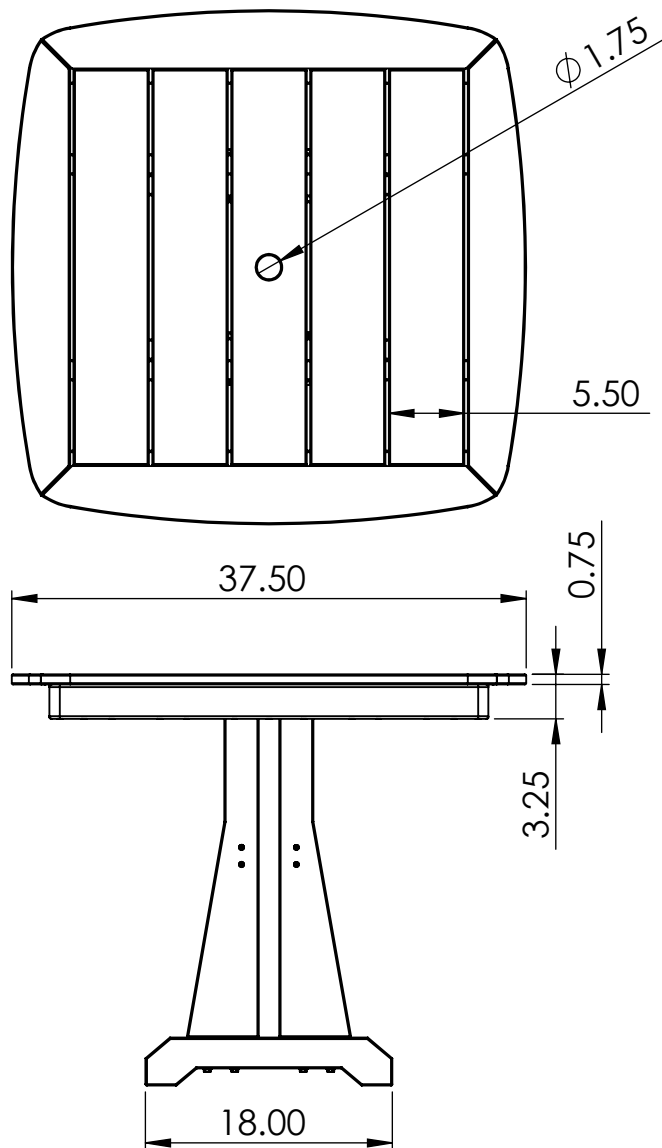

**CONSTRUCTION MATERIALS:**  
Recycled Plastic  
**HARDWARE:**  
Stainless Steel

ALL DIMENSIONS SHOWN IN INCHES