

DUAL ADA WOOD PICNIC TABLE (FRAME ONLY)

KTB3007FR1
REV. 1
10/21/24

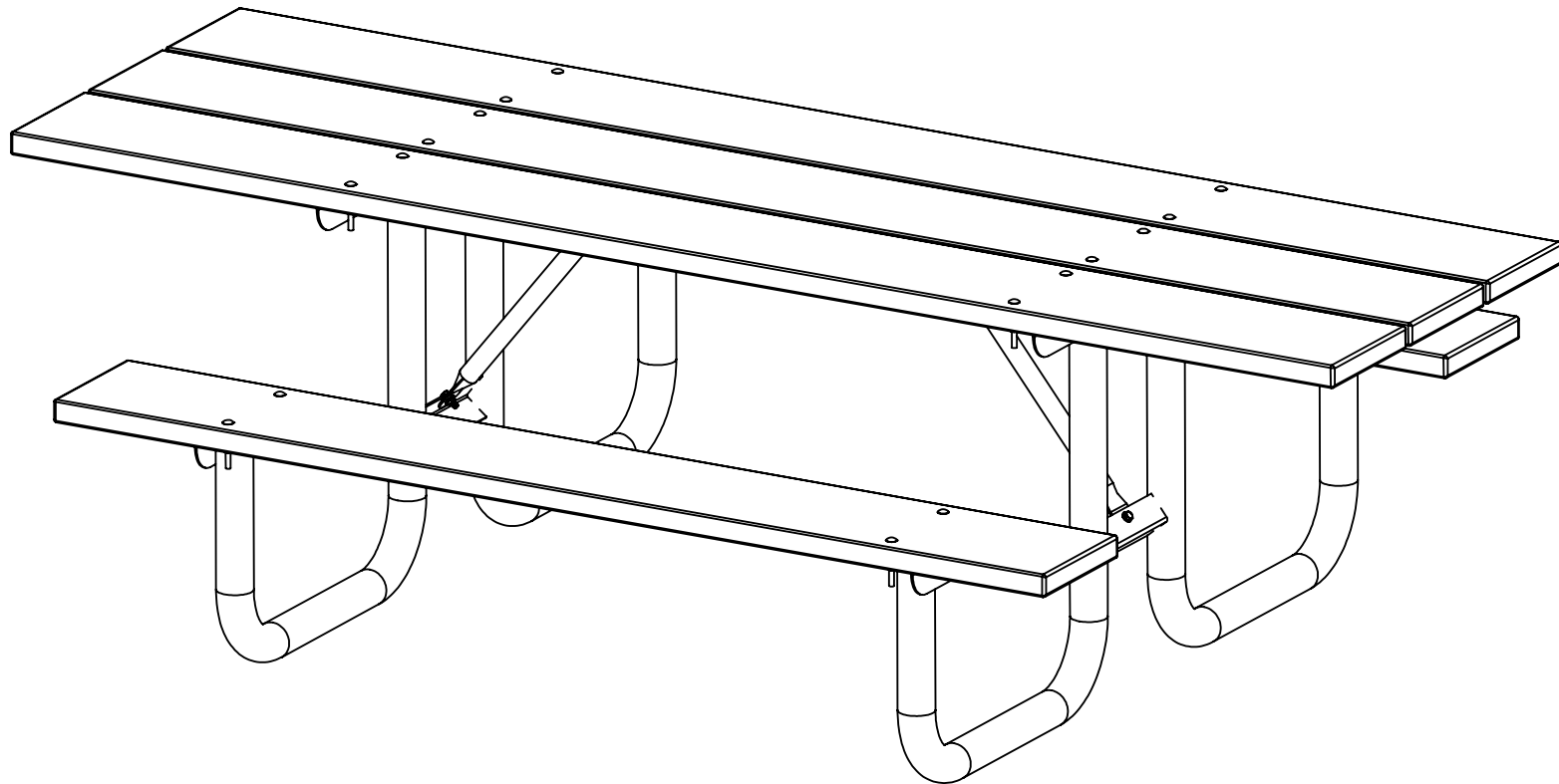

DUAL ADA WOOD PICNIC TABLE (FRAME ONLY)

07XY3000FR1-LEG
QTY. 2

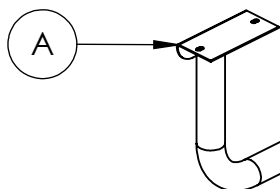

07XY3000FR-ASB
QTY. 2

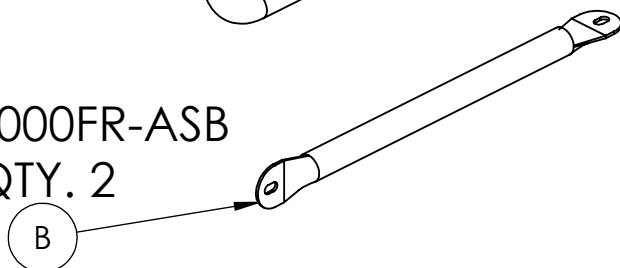

07XY3000FR-CC
QTY. 2

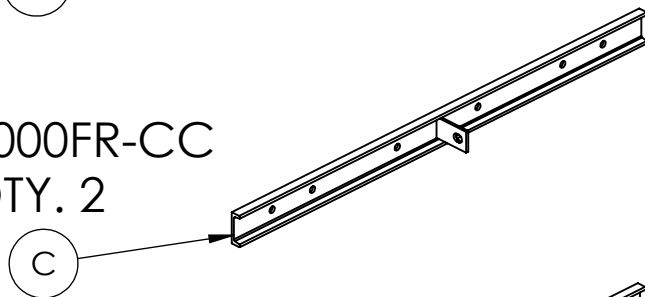

07XY3007FS1-EC
QTY. 2

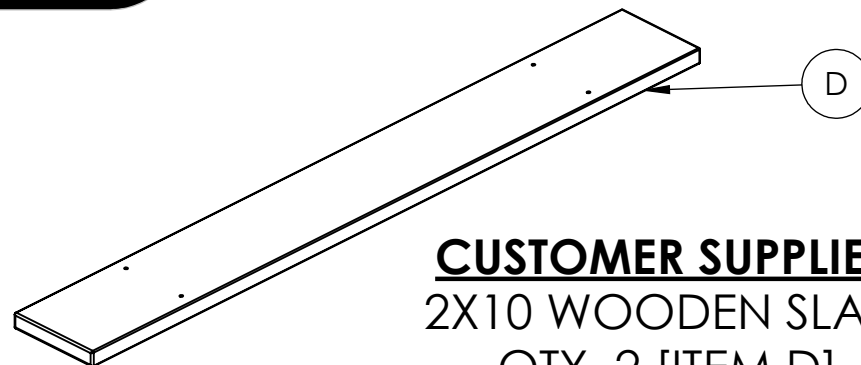
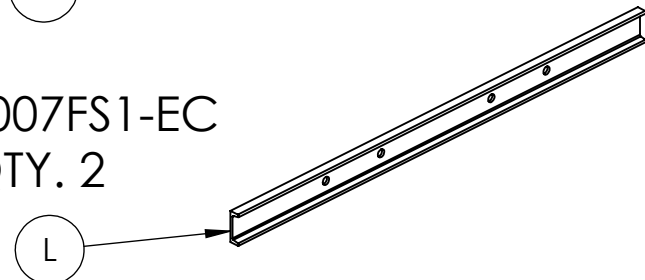

CUSTOMER SUPPLIED
2X10 WOODEN SLATS
QTY. 2 [ITEM D]
QTY. 3 [ITEM E]
(SEE NEXT PAGE FOR
DRILLING INSTRUCTIONS)

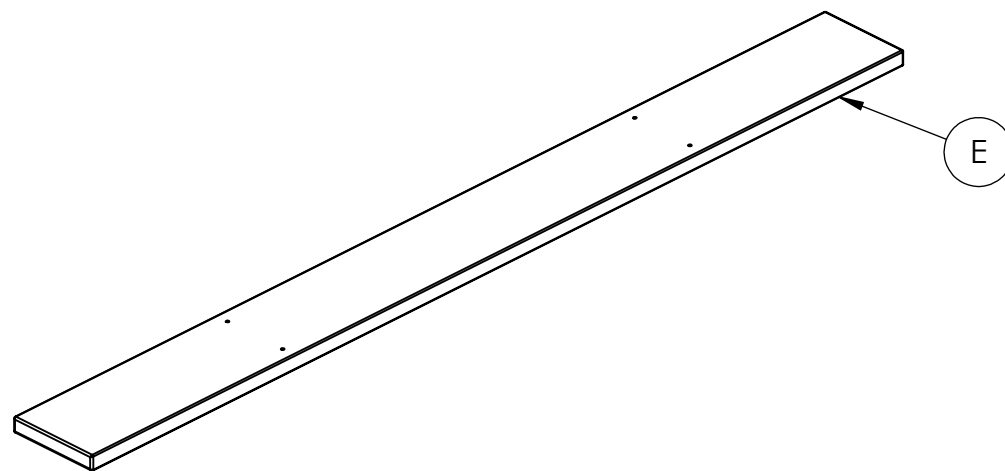

**COMPONENTS
REQUIRED FOR
ASSEMBLY**

1/7

DUAL ADA WOOD PICNIC TABLE (FRAME ONLY)

WHEN SUPPLYING YOUR OWN WOODEN SLATS, KEEP IN MIND:

- YOU SHOULD NOT ASSUME THAT THE END CUTS ARE SQUARE. TRIMMING MAY BE NECESSARY.
- SOME 2x10's ARE SLIGHTLY LESS THAN 9.250" WIDE. HOLD THE 6.50" AND 48.00 DIMENSIONS.
- DRILL THE 5/16" (0.313") HOLES AS PERPENDICULAR TO THE SURFACE AS POSSIBLE.
- THE CARRIAGE BOLT MUST FIT TIGHTLY IN THE 5/16" (0.313") HOLE. DON'T MAKE HOLES ANY BIGGER.
- SMOOTHING OVER THE END CUTS WITH A HAND ROUTER IS SUGGESTED.

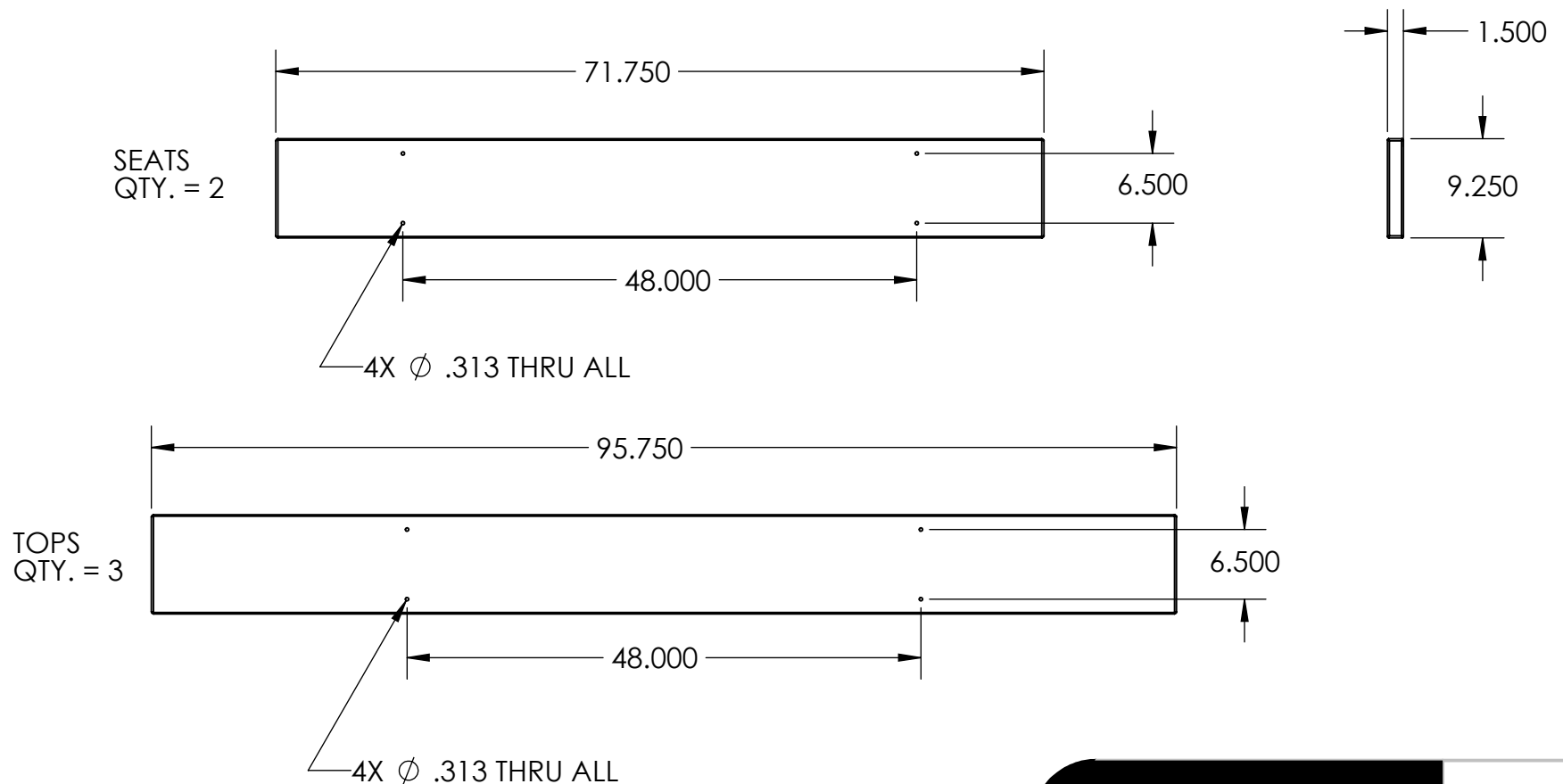

**DRILLING
DETAIL**

2/8

DUAL ADA WOOD PICNIC TABLE (FRAME ONLY)

5/16" X 1" HEX HEAD
QTY. 4

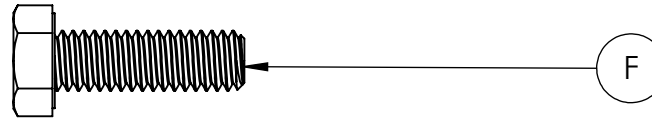

5/16" X 2-1/2"
CARRIAGE BOLT
QTY. 20

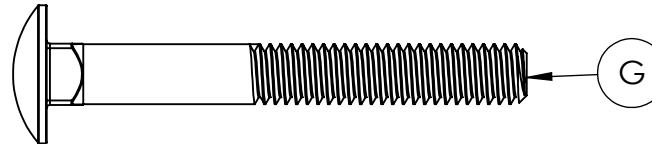

5/16" FLANGE NUT
QTY. 24

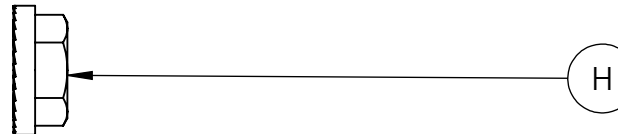

M5*25 LAG SCREW
QTY. 20



5/16" FLAT WASHER
QTY. 4

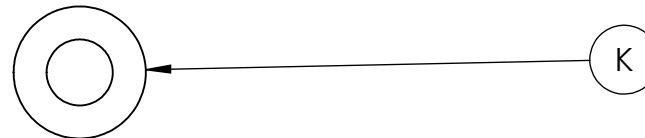

REQUIRED TOOLS (NOT INCLUDED)

POWER DRILL
#2 PHILLIPS OR 3mm SOCKET
1 - 1/2" WRENCH
1 - 1/2" DEEP SOCKET
1 - 1/8" DRILL BIT (OPTIONAL)
1 - RUBBER Mallet

**NOTE: IT IS IMPORTANT TO KEEP ALL BOLTS FINGER TIGHT
DURING ASSEMBLY UNTIL ENTIRE TABLE IS ASSEMBLED**

**HARDWARE &
TOOLS REQUIRED
FOR ASSEMBLY**

3/8

DUAL ADA WOOD PICNIC TABLE (FRAME ONLY)

STEP 1: BEGIN BY LIFTING ONE END OF A SEAT SLAT AND PLACING IT ON THE LEG WELDMENT AS SHOWN. BE SURE TO ORIENT THE LEG SO THE VERTICAL SECTION OF THE FLANGES ARE FACING TO THE OUTSIDE, AS-SHOWN. CHOOSE THE BETTER SIDE OF THE BOARDS TO FACE UP.

THE OTHER END OF THE SEAT REMAINS ON THE GROUND.

HOLDING THE LEG UPRIGHT BUT AT A SLIGHT ANGLE TO MATCH THE SEAT, INSERT (2) CARRIAGE BOLTS (G) THROUGH THE HOLES IN THE WOODEN SLAT AND INTO THE SLOTS IN THE METAL LEG. TAP WITH A RUBBER Mallet TO SEAT THE SQUARE SHOULDER INTO THE WOOD. THREAD ON A FLANGE NUT (H) ONTO EACH CARRIAGE BOLT, FINGER TIGHT.

DO THE SAME FOR THE OTHER SEAT.

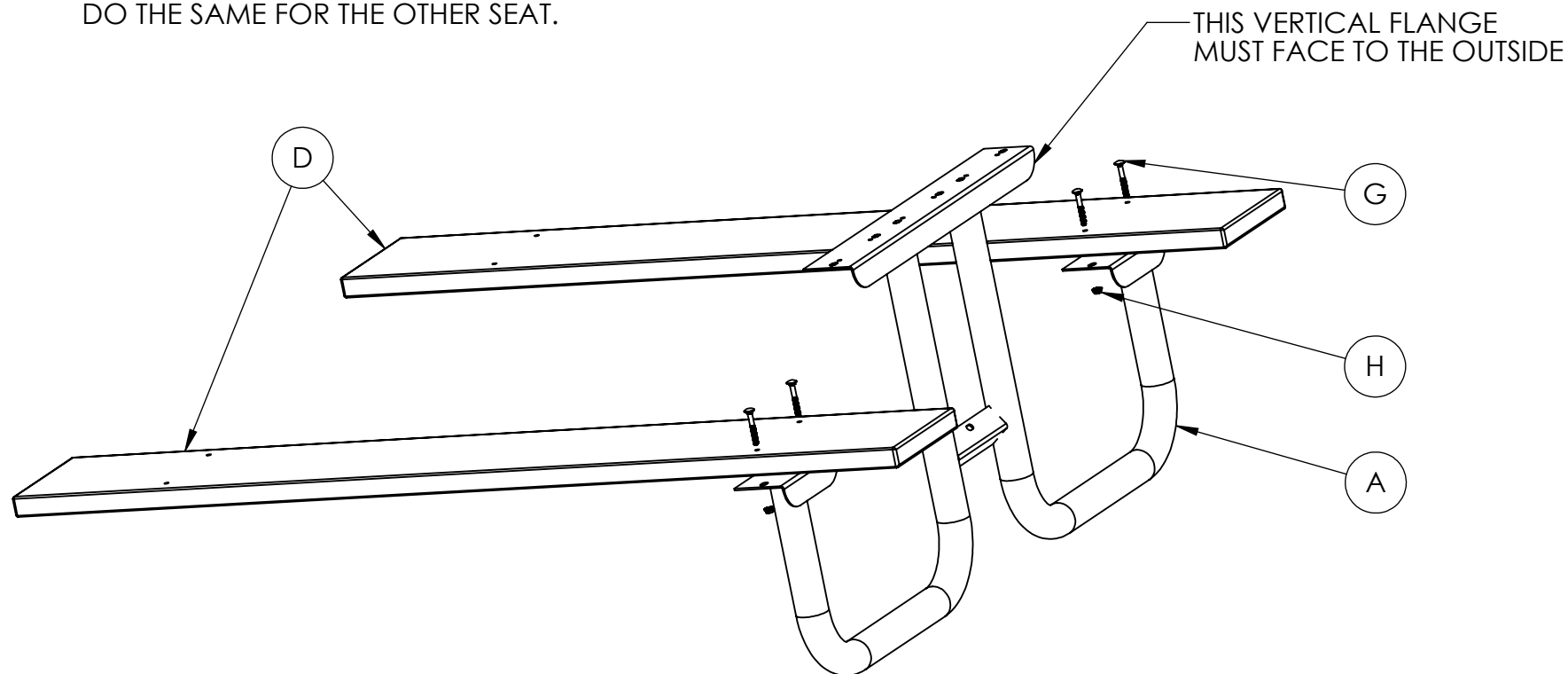

DUAL ADA WOOD PICNIC TABLE (FRAME ONLY)

STEP 2: SLIDE THE OTHER LEG (A) UNDER THE SEATS, WHICH ARE SITTING AT AN ANGLE TO THE GROUND AT THIS POINT. IT IS EASIEST TO THEN STAND THE LEG UPRIGHT. AS IT MOVES INTO AN UPRIGHT POSITION, IT WILL LIFT BOTH SEATS WITH IT. AGAIN, MAKE SURE THE LEG IS ORIENTED CORRECTLY.

INSERT (4) CARRIAGE BOLTS (G), THROUGH THE WOODEN SLATS AND INTO THE SLOTS IN THE METAL LEG (A). TAP WITH A RUBBER Mallet TO SEAT THE SQUARE SHOULDER INTO THE WOOD.

INSTALL (4) FLANGE NUTS (H), ONTO THE (4) CARRIAGE BOLTS AND TIGHTEN FINGER TIGHT.

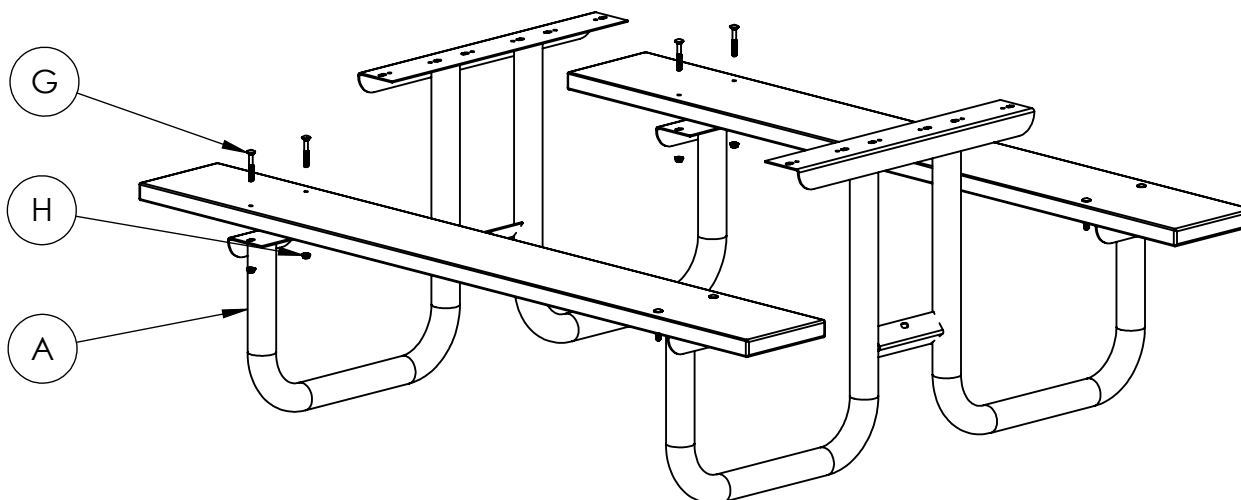

DUAL ADA WOOD PICNIC TABLE (FRAME ONLY)

STEP 3: INSTALL THE ANGLE SUPPORT BRACE (B) TO THE SHORT PIECE OF METAL BETWEEN THE LEG TUBES. THE ANGLE SUPPORT BRACE IS THE SAME ON BOTH ENDS. AT THE BOTTOM OF THE ANGLE SUPPORT BRACE, SECURE IT USING A 5/16" X 1" HEX BOLT (F), A 5/16" FLAT WASHER (K), AND A FLANGE NUT (H). THE FLAT WASHER IS FOR UNDER THE HEAD OF THE MACHINE SCREW, AS SHOWN. TIGHTEN THEM FINGER TIGHT.

AT THE TOP END OF THE ANGLE SUPPORT BRACE (B), ATTACH THE C-CHANNEL (C). THE TAB ON THE C-CHANNEL CAN GO ON EITHER SIDE OF THE ANGLE SUPPORT BRACE. USE A 5/16" X 1" HEX BOLT (F), A 5/16" FLAT WASHER (K), AND A FLANGE NUT (H) TO ATTACH IT. AGAIN, THE WASHER GOES UNDER THE HEAD OF THE SCREW AS SHOWN. TIGHTEN FINGER TIGHT AND INSTALL THE OTHER ANGLE SUPPORT AND C-CHANNEL ON THE OTHER LEG.

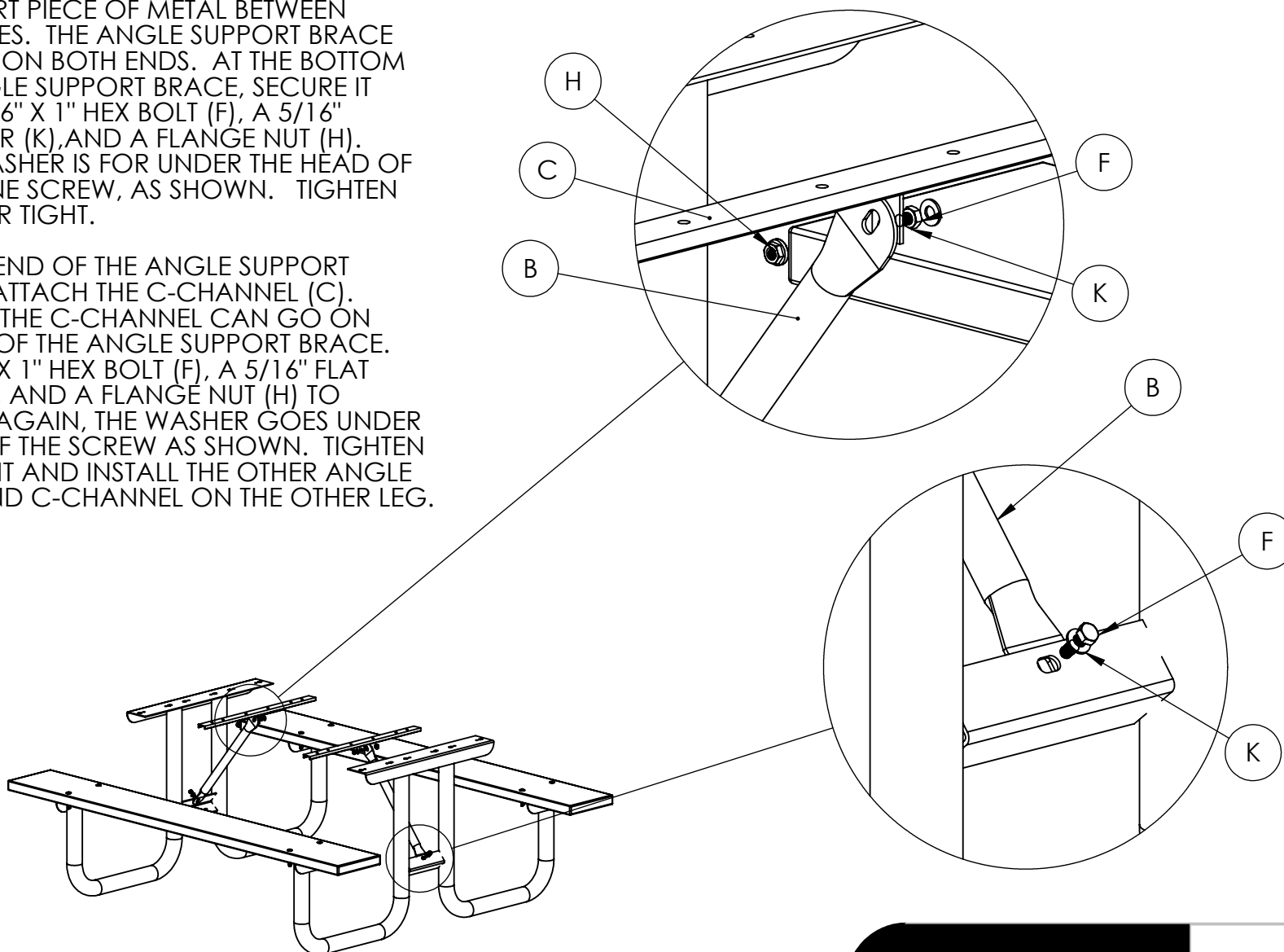

**ATTACH ANGLE
SUPPORTS**

6/8

DUAL ADA WOOD PICNIC TABLE (FRAME ONLY)

STEP 4: PLACE THE TOP SLATS (E) ON THE TABLE AS-SHOWN, CHOOSING THE BETTER SIDE TO FACE UP.

INSTALL (12) CARRIAGE BOLTS (G) THROUGH THE HOLES AND INTO THE SLOTS IN THE METAL LEGS. THE TOPS OF THE METAL LEGS MAY NEED TO BE FORCED SLIGHTLY INWARD OR OUTWARD FOR THE HOLES TO LINE UP. ONCE THE BOLTS ARE IN THE SLOTS IN THE METAL FLANGES, TAP WITH A RUBBER Mallet TO SEAT THE SQUARE SHOULDER INTO THE WOOD.

THREAD ON A FLANGE NUT (H) ONTO EACH CARRIAGE BOLT AND TIGHTEN FINGER TIGHT.

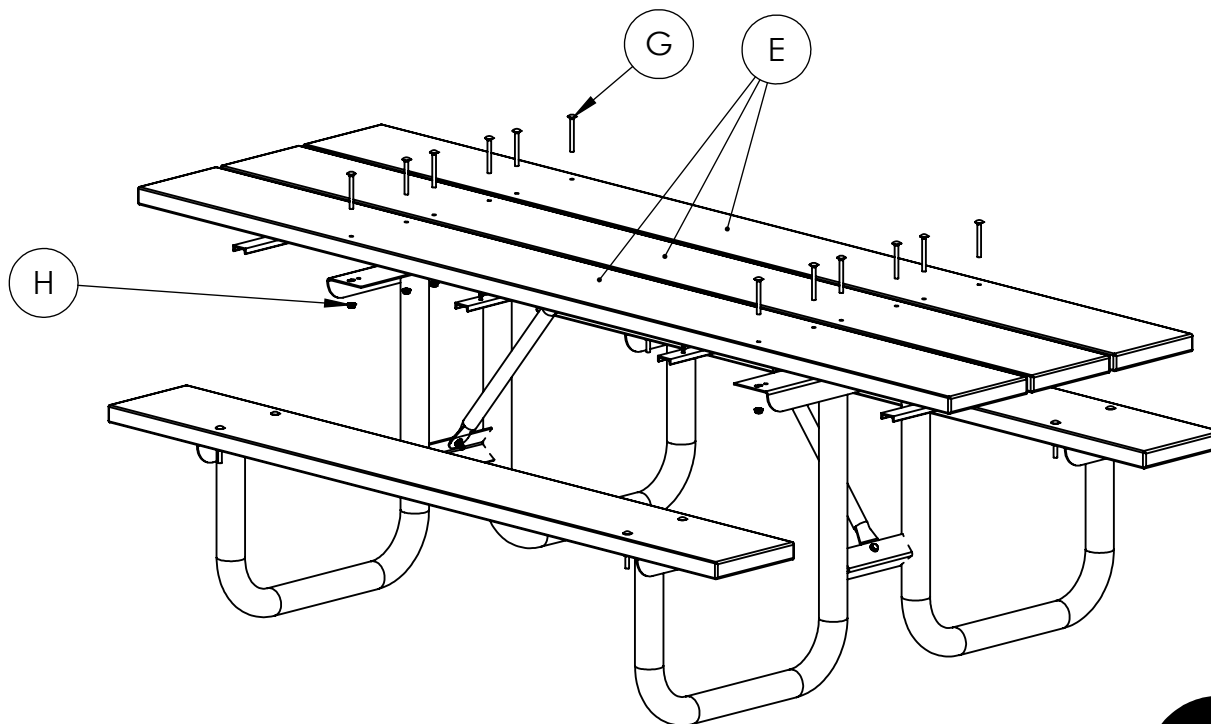

**ATTACH TOP
SLATS**

7/8

DUAL ADA WOOD PICNIC TABLE (FRAME ONLY)

STEP 5:

FROM UNDERNEATH THE TABLE, INSTALL (20) M5*25 LAG SCREWS (J) THROUGH THE C-CHANNELS (C) AND THE EDGE CHANNEL (L) INTO THE WOOD SLATS. PREDRILLING AN 1/8" HOLE ABOUT 1/2" DEEP WILL MAKE THIS STEP EASIER BUT IS NOT NECESSARY.

TAKE NOTE OF HOW THE EDGE CHANNEL (L) IS INSTALLED WITH THE TIPS FACING DOWN. THIS PART IS NECESSARY TO KEEP THE ENDS OF THE BOARDS LINED UP WITH EACHOTHER.

GO BACK AND FULLY TIGHTEN ALL NUTS (H) AND SNUG DOWN SCREWS (J) WITHOUT OVER TIGHTENING THEM BEFORE USING YOUR PICNIC TABLE.

SIDE VIEW
(END OF
TABLE TOP)

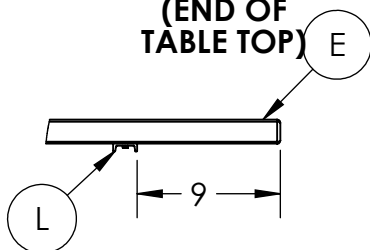

SINCE THERE ARE NO PILOT HOLES TO GUIDE WHERE PART (L) IS MOUNTED, THE 9" SPACING FROM THE END IS THE SUGGESTED LOCATION TO COMPLY WITH ADA GUIDELINES FOR KNEE SPACE.

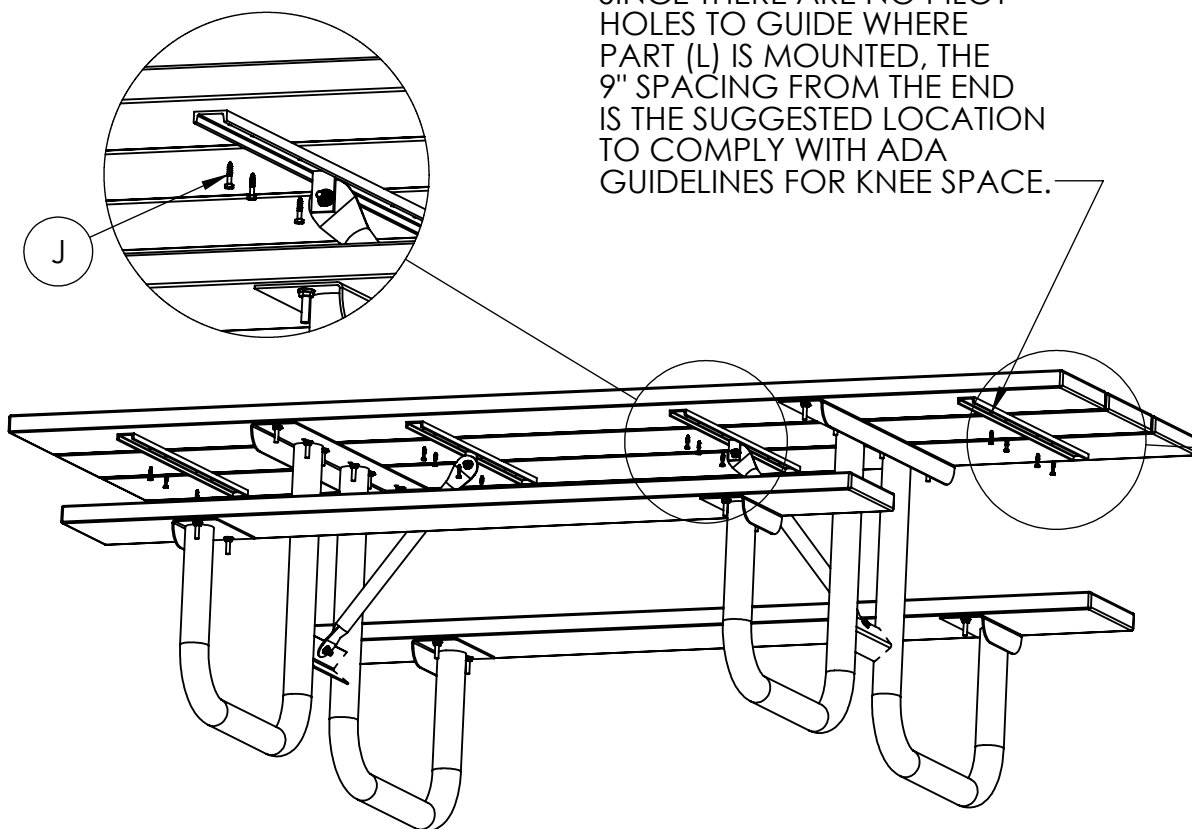

INSTALL THIS
CHANNEL
WITH THE "U"
FACING DOWN.

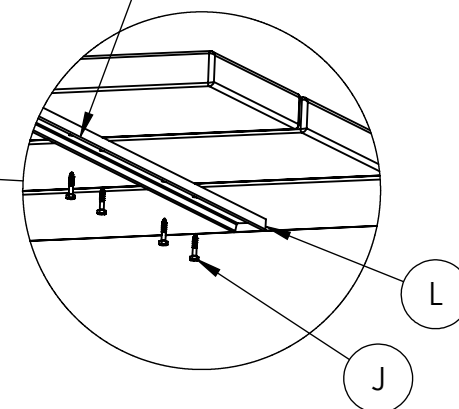

**INSTALL
LAG BOLTS**

8/8

DUAL ADA WOOD PICNIC TABLE (FRAME ONLY)

KTB3007FR1

ALL DIMENSIONS ARE SHOWN IN INCHES

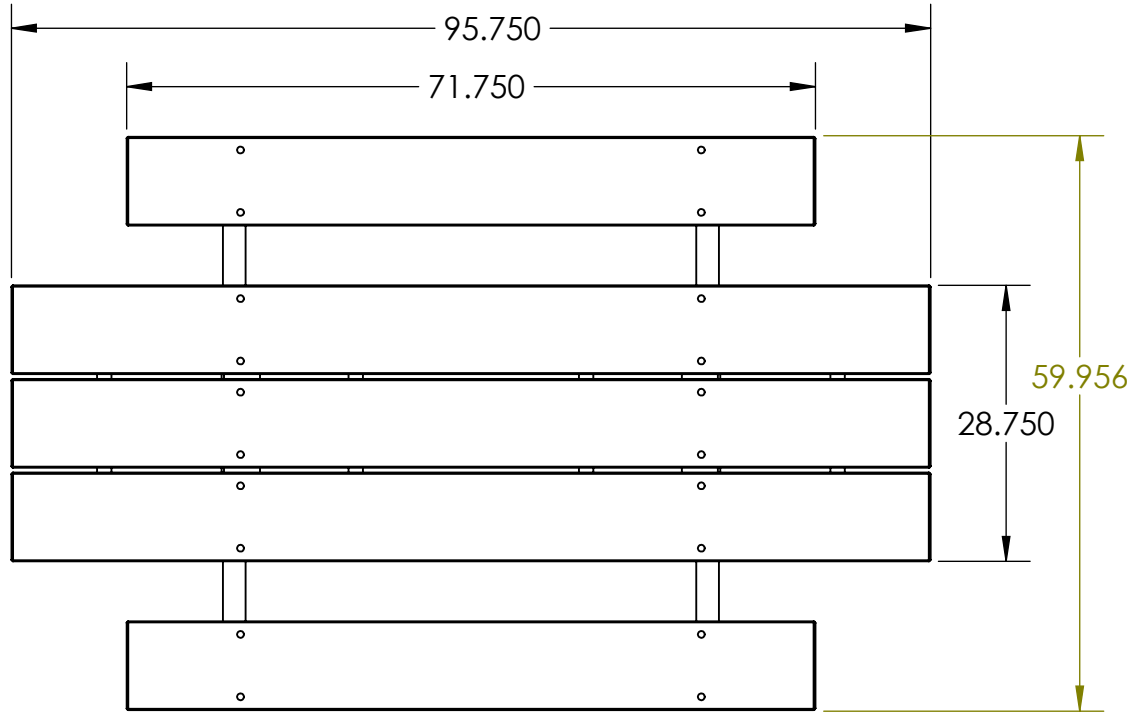

TOP

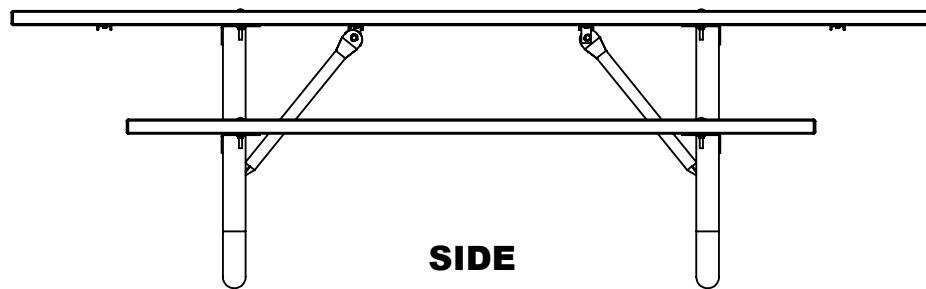

SIDE

**DIMENSIONS SHOWN ARE
CLOSE APPROXIMATIONS
BECAUSE CUSTOMER IS
ADDING THEIR OWN
WOODEN SLATS.**

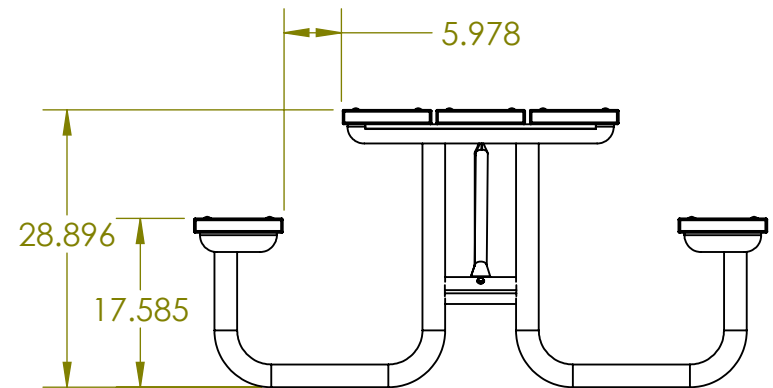
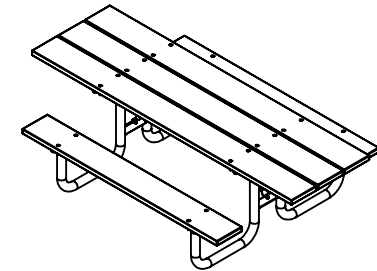

END